

PRICELIST & SPECIFICATION

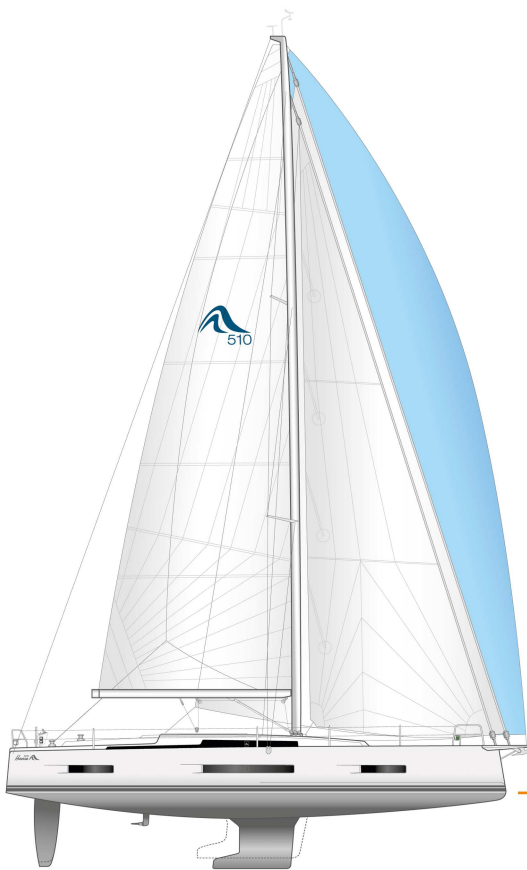

LOA		15.97 m	52' 5"
Hull length		15.25 m	50' 0"
LWL		14.40 m	47' 3"
Beam		4.91 m	16' 1"
Draft			
shallow keel		1.98 m	6' 6"
L-keel, medium		2.43 m	7' 12"

Displacement			
L-keel, medium	approx.	16.54 t	36,475 lbs

Engine Diesel			
standard	approx.	80 PS	80 hp
option	approx.	110 PS	110 hp

Fuel tank	approx.	200 l	53 gal
Fresh water	approx.	450 l	119 gal

CE Certificate	A - 12, B - 14, C - 18
Design	Berret - Racoupeau
Interior	Berret - Racoupeau

Mast length above WL	approx.	23.55 m	77' 3"
Upwind sail area	approx.	128.00 m ²	1,377 sq ft
Downwind sail area	approx.	255.00 m ²	2,744 sq ft
Main sail	approx.	66.00 m ²	710 sq ft
Jib	approx.	53.00 m ²	570 sq ft
Genoa	approx.	62.00 m ²	667 sq ft
Reacher	approx.	94.00 m ²	1011 sq ft
Gennaker	approx.	189.00 m ²	2,034 sq ft

510

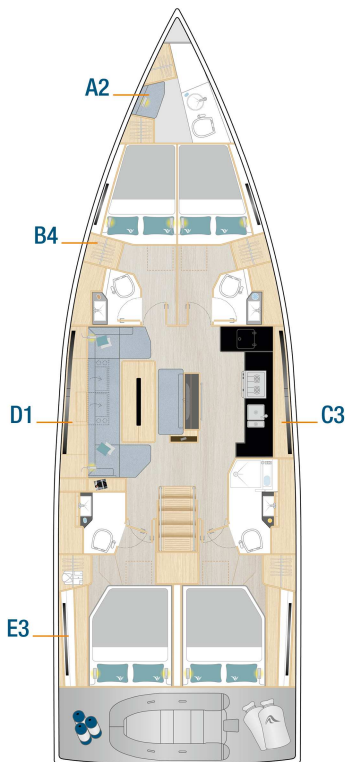
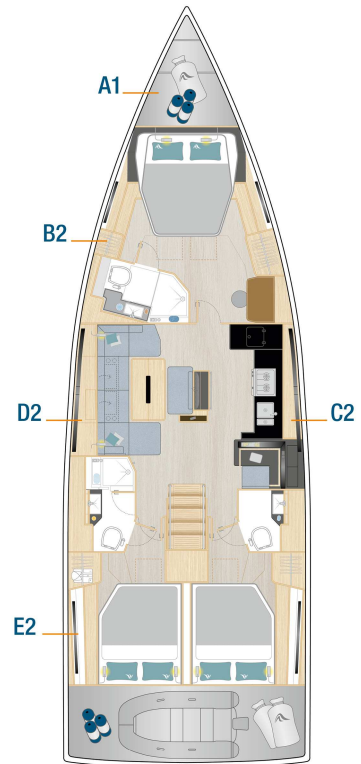
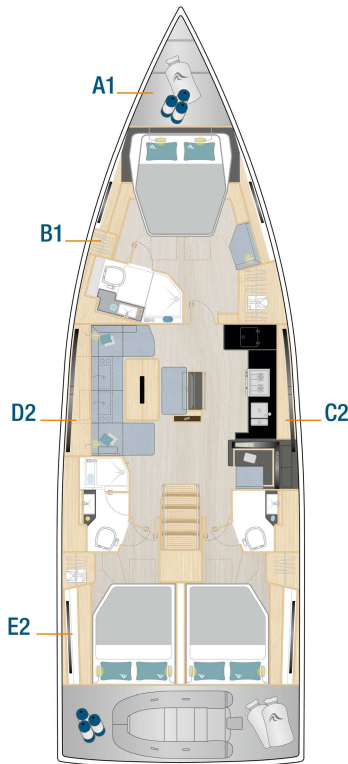
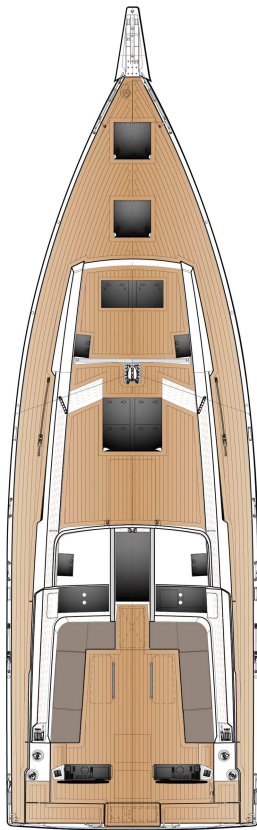

Option

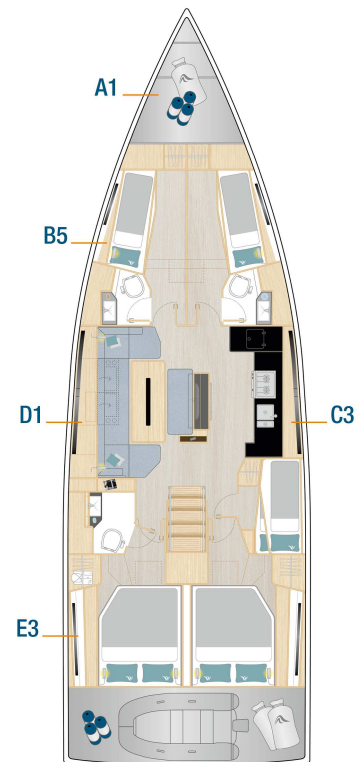
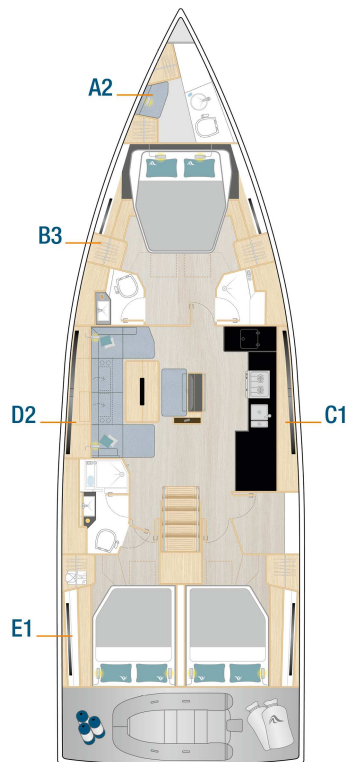

HULL

- 8 hull windows (4 each side)
- GRP hull, isophthalic gelcoat, colour: Signal White (RAL 9003), 1st layer vinyl ester resin and balsa sandwich laminat
- Waterline and cove line, isophthalic gelcoat, colour: Dark Grey (RAL 7043)

KEEL

- L-keel, cast iron, draft: 2.43 m
- GRP rudder with sea-water resistant aluminium shaft and selfaligning bearings

LAYOUT & INTERIOR

- A1: Saillocker
- B1: Enlarged master cabin with island double berth, 2 lockers, seating area and ensuite head with separate shower stall (only with A1 layout)
- C1: Saloon with full functional large L-galley on stb (only with E1 or E2 layout)
- D1: Spacious saloon with large dining area with bar, library and head on port
- E1: 2 aft cabins with double berth, storage space and storage room on stb (only with C1 or C2 layout)
- 3-burner gas stove with oven, waste bin, 12 V fridge approx. 135 l, double stainless steel sink with mixing tap
- Interior furniture in high quality marine plywood, Satin Varnish
- Hanse companionway closing system
- Saloon table, fixed
- Worktop in galley and heads - Black Quartz

WOOD (FURNITURE, FLOORBOARD)

- Furniture - Mahogany Style, Satin Varnish
- Galley cupboard fronts in wood colour
- Floorboard - Acacia

UPHOLSTERY

- Mattresses for all berths
- Upholstery - Monte Carlo, colour: Cream

DECK & OUTSIDE EQUIPMENT

- GRP deck with antislip surface, isophthalic gelcoat, colour: Signal White (RAL 9003), 1st layer vinyl ester resin with balsa sandwich core. 2 cockpit lockers, 1 space for life raft, dinghy garage, stowage for running rigging at helm position and in the steps from the cockpit to side deck, anchor locker at bow.
- Teak on cockpit bottom
- Teak on cockpit benches
- Teak on bathing platform
- Twin wheel steering system with emergency tiller
- 2 stainless steel steering wheels with leather cover
- Cockpit table, stainless steel with teak tops, on stb
- Cockpit table, stainless steel with teak tops, on ps
- Pulpit and pushpit, stainless steel
- Railing, incl. stanchions and stainless steel wire
- Covered halyards and control lines lead to cockpit helmposition, organizers and jammers, 4 mooring cleats, handrails on coach roof
- 2 LEWMAR 50 ST EVO manual halyard winches
- Bathing platform, manual fold-out with swimming ladder
- Composite bowsprit with integrated anchor and forestay fitting, gennaker eye
- Self tacking jib system
- Mainsheet system
- 8 large and 6 small deck hatches - openable, anchor locker hatch
- 4 large coach roof side windows - openable, 4 portlights in coach roof

RIG & SAILS

- Rig, anodized aluminium, deck stepped, with kicker, standing and running rigging and 2 reefs
- Backstay tensioner, manual
- Manual jib furler
- QUANTUM Dacron sails - full battened, main and jib
- Dyneema halyards for main and jib

NAVIGATION & INSTRUMENTS

- Illuminated compass at each helm
- Navigation lights - LED

PROPULSION

- Fuel tank, approx. 200 l
- Engine (Diesel, approx. 80 hp) - saildrive, 3-blade fix propeller

EQUIPMENT

- 12 V and 230 V electric system with main panels and 230 V shore power and sockets in cabins and heads
- Battery set, capacity: 1x 90 Ah + 2x 160 Ah AGM
- Country Version: EU / AUS
- Battery charger 50 A
- Manual toilet with sea water flush - cabin layout B1, B2 or B3
- Manual toilet with sea water flush - cabin layout D1 or D2
- LPG gas system, stowage for 1 gas bottle
- Black water system (appr. 85 l each bathroom) with deck extraction and seacock for head, electric and manual bilge pump
- Fresh water tank, appr. 450 l
- Fresh water system with electric pump and 40 l hot water, heated also by main engine

SHIPPING & TRANSPORT

- CE - Certificate cat. A - 12, B - 14, C - 18
- Owners manual
- EC - Type Examination Certificate

AS PER STANDARD SPECIFICATION

excl. VAT
449.900 €

PACKAGES

XW2000 B&G Navigation Package 14.490 €

XF2000	2 instrument pods (1 per helm station)
XF2200	2 B&G Triton ² multifunction displays, 1 per helm station, incl. transducer (wind/depth/speed/temperature)
XF3000	B&G VHF V60 at chart table, incl. wireless remote handset H60 (only with XK5000)
XF4030	B&G Zeus ³ S 9" chart plotter at helm station, stb
XF5000	B&G Autopilot with Triton ² control unit with WR10 remote control and Precision 9 compass
XH2090	Wireless charging at helm station (waterproof)
XK5000	VHF preparation with antenna and splitter for FM and AIS

XW2001 Upgrade - second chart plotter 2.490 €

XF4031	B&G Zeus ³ S 9" chart plotter at helm station, ps
--------	--

XW2002 Upgrade - 12" chart plotter 4.790 €

XF4040	B&G Zeus ³ S 12" chart plotter at helm station, stb
XF4041	B&G Zeus ³ S 12" chart plotter at helm station, ps

XW3000 Cruising Package 12.590 €

XC1333	Teak on helmsman seats (only with XC9060)
XC9060	2 helmsman seats, foldable (only with XC1333 or XC1334)
XC9062	Helmsman footrests (free mountable)
XC9080	2 additional cleats, midship (1 each side)
XC9090	Anchor windlass, electrical, 1000 W, automatic fuse, remote control
XC9100	Delta-anchor 25 kg, galvanized with 60 m galvanized chain
XC9402	Cockpit portlight, aft cabins
XF4550	MyHanse Safety Cloud with 24 months subscription and device installed on board
XH1001	Battery set, capacity: 1x 90 Ah + 4x 160 Ah AGM
XH1110	Deep charge protection for service batteries
XH3110	Shower unit in cockpit, warm-/coldwater
XH5030	Water akku for pressure equalization
XV9420	Wind indicator

XV9450	Flagpole
XV9901	6 fenders
XV9902	4 mooring lines
XV9910	Add. winch handle
XV9920	Mast steps
XV9950	Hanse maintenance kit

XW3001	Upgrade - Flexiteek (colour selection)	990 €
---------------	---	--------------

XC1326	Flexiteek on cockpit bottom
XC1334	Flexiteek on helmsman seats (colour selection - only with XC9060)
XC1341	Flexiteek on cockpit benches
XC1351	Flexiteek on bathing platform

XW3002	Upgrade - stainless steel anchor with chain	4.490 €
---------------	--	----------------

XC9101	Delta-anchor 25 kg, stainless steel, with 'Ultra swiffel' swivel and 100 m stainless steel chain
--------	--

XW3003	Upgrade - Anchor windlass 1500 W	1.890 €
---------------	---	----------------

XC9088	Combined mooring/anchor windlass, electrical, 1500 W, automatic fuse, remote control with chain counter (only with XH1001 or XH1005)
--------	--

XW3004	Upgrade - Battery set Lithium	8.390 €
---------------	--------------------------------------	----------------

XH1005	Battery set, capacity: 1x 90 Ah + 6x 105 Ah Lithium
--------	---

XW3005	Upgrade - 4 enlarged retractable cleats	3.490 €
---------------	--	----------------

XC9081	4 enlarged cleats - bow and stern, retractable and 4 standard size cleats, retractable - midship (2 each side)
--------	--

XW3006	Upgrade - MyHanse Safety Cloud extention	3.890 €
---------------	---	----------------

XF4655	Interior camera
XH5409	Gas leak detector
XK5031	WLAN router with active booster antenna
XL9005	Light in navigation area, switchable by APP

XW4000	Performance Package	9.490 €
---------------	----------------------------	----------------

XC2201	2 GRP steering wheels, Y-spoke (black or white)
XE3005	QUANTUM AC5 performance sails - full battened, triradial main and jib
XE9002	Selden MDS mainsail slider system

XW4100 Gennaker Package 7.390 €

- XE3100 QUANTUM Gennaker (colour selection - only with XC9171)
- XE3110 Squeezer for Gennaker
- XE9003 Gennaker package incl. halyard, 2 sheets, 2 blocks and padeyes (only with XC9171)

XW5000 Comfort Package 8.390 €

- XC9032 Courtesy lights in cockpit
- XC9033 Courtesy lights at companionway
- XC9040 Exterior Light Signature
- XC9300 2 vents for coach roof hatches
- XL9001 Courtesy lights in saloon
- XL9003 Indirect lights in saloon and cabins
- XL9004 LED overhead lights in saloon and cabins, dimmable
- XL9010 SLS - Scenario light system - touch screen controller and dimmer in saloon and fwd cabin
- XN2500 Cockpit cushions (colour selection)
- XV9010 Blind set with flyscreens for deck hatches
- XV9060 Blinds for hull windows
- XV9080 Blinds for side coach roof windows

XW6000 Flagship Package 10.490 €

- XL7235 Headboards for aft cabins
- XL7410 Leather covered handrails
- XL7420 Soft material covered bulkheads in the saloon
- XN2055 Luxury upholstery with multifunction backrests

XW7000 FUSION Entertainment Package - Saloon 3.590 €

- XK1000 FUSION APOLLO MS-RA770 Multimedia radio with Wi-Fi and touchscreen - for saloon and cockpit (only with XK5000)
- XK1200 Subwoofer with integrated amplifier in saloon
- XK2040 4 high-end speakers in saloon
- XK2070 2 high-end speakers in cockpit
- XK3000 FUSION MS-ERX400 remote control in cockpit
- XK5030 FUSION wireless link - remote control via mobile devices

XW7001 FUSION Entertainment Package - Master cabin (only with B1 or B2 layout) 3.890 €

- XK1010 FUSION APOLLO MS-RA770 Multimedia radio with Wi-Fi and touchscreen - for master cabin (only with XK5000)
- XK2010 2 high-end speakers in master cabin

XW7010 JL Entertainment Package - Saloon 7.190 €

- XK1001 JL Media Master MM50 with Bluetooth - for saloon and cockpit (only with XK5000)
- XK2041 4 JL Audio speakers in saloon
- XK2071 2 JL Audio speakers in cockpit
- XK3001 JL Audio MMR-40 remote control in cockpit

XW7011 JL Entertainment Package - Master cabin (only with B1 or B2 layout) 4.490 €

- XK1011 JL Media Master MM50 with Bluetooth - for master cabin (only with XK5000)
- XK2011 2 JL Audio speakers in master cabin

XW7030 TV Package - Saloon 4.490 €

- XK4100 LED TV flat screen in saloon
- XK4240 TV lifting system in saloon
- XK5020 DVB-T2 antenna for TV

OPTIONS

excl. VAT

HULL

- XA1001 GRP hull, gelcoat colour: Grey (RAL 7040) 6.090 €
- XA1002 GRP hull, painted, non metallic (colour selection) 27.790 €
- XA1003 GRP hull, painted, metallic (colour selection) 34.590 €
- XA3001 Waterline and cove line, coloured gelcoat (colour selection - only with XA1000 or XA1001) 890 €
- XA3002 Waterline and cove line, painted, non metallic (colour selection - only with XA1002 or XA1003) 990 €
- XA3003 Waterline and cove line, painted, metallic (colour selection - only with XA1002 or XA1003) 1.190 €

KEEL

- XB1001 L-keel, cast iron, draft: 1.98 m 4.190 €
- XB9000 Keel and rudder - not mounted 1.090 €

LAYOUT & INTERIOR

XL1002	A2: Crew cabin with sink, toilet and storage space (only with B3, B4 or B5 layout)	8.390 €
XL2002	B2: Enlarged Master cabin with island double berth, vanity table and ensuite head with separate shower stall (only with A1 layout)	1.090 €
XL2003	B3: Master cabin with island double berth, 2 lockers, ensuite head and separate shower stall	2.790 €
XL2004	B4: 2 fwd cabins with double berth, storage space and separate heads	5.290 €
XL2005	B5: 2 fwd cabins with bunk berth, storage space and separate heads	5.490 €
XL3002	C2: Saloon with full functional U-galley and chart table on stb (only with E1 or E2 layout)	3.590 €
XL3003	C3: Saloon with full functional L-galley on stb (only with E3 or E4 layout)	990 €
XL4002	D2: Saloon with dining area with bar and head with separate shower stall on port	1.190 €
XL5002	E2: 2 aft cabins with double berth, storage space and ensuite head on stb (only with C1 or C2 layout)	1.890 €
XL5003	E3: 2 aft cabins with double berth, storage space and ensuite head on port and ensuite head with separate shower stall on stb (only with C3 layout)	3.490 €
XL5004	E4: 2 aft cabins with double berth, storage space and cabin on stb with double bunkbed (only with C3 layout)	1.690 €
XL6010	Furniture for utility room instead of storage room in layout E1	1.690 €
XL6050	Day head door for head in saloon on port side (only with E2 or E3 layout)	1.090 €
XL7001	Saloon table electrically lowerable with cushions, convertible into double berth, for D2 layout	2.790 €
XL7002	Large saloon table electrically lowerable with cushions, convertible into double berth, for D1 layout	4.990 €
XL7601	Worktop in galley and heads - Off White	890 €
XL7602	Worktop and sink of the galley in Marine Mineral Stone (colour selection)	2.990 €

WOOD (FURNITURE, FLOORBOARD)

XM1102	Furniture - Teak	6.290 €
XM1103	Furniture - Canadian Chestnut	6.290 €
XM1104	Furniture - French Oak	6.290 €
XM1161	Galley cupboard fronts coloured (partial as per design - colour selection)	2.090 €
XM1201	Floorboard - Classic Stripes	2.190 €
XM1202	Floorboard - Noce Nero	1.190 €
XM1203	Floorboard - Delight Oak	1.190 €
XM9000	Floorboard - wooden grating in all heads and showers	1.690 €

UPHOLSTERY

XN1100	Comfort mattresses for all berths (excluded A2, B5 and E4 layout)	3.490 €
XN2001	Upholstery - Sorrento (colour selection)	1.390 €

XN2002	Upholstery - Florence (colour selection)	2.090 €
XN2003	Upholstery - Monaco (colour selection)	3.190 €
XN2004	Upholstery - Portofino Leather (colour selection)	6.290 €
XN2400	Sun bed cushions on coach roof (colour selection)	2.190 €
XN2503	Cushion for helmsman seats (colour selection - only with XC9060)	790 €
XN2505	Cushion for wetbar (colour selection - only with XC3100)	490 €

DECK & OUTSIDE EQUIPMENT

XC1300	Teak on side deck	20.490 €
XC1301	Flexiteek on side deck (colour selection)	21.590 €
XC1310	Teak on coach roof	7.190 €
XC1311	Flexiteek on coach roof (colour selection)	7.890 €
XC1326	Flexiteek on cockpit bottom	2.190 €
XC1333	Teak on helmsman seats (only with XC9060)	1.090 €
XC1334	Flexiteek on helmsman seats (colour selection - only with XC9060)	1.190 €
XC1341	Flexiteek on cockpit benches	590 €
XC1351	Flexiteek on bathing platform	1.290 €
XC2201	2 GRP steering wheels, Y-spoke (black or white)	1.890 €
XC3004	Cockpit table with teak top, electrically lowerable into sunbed incl. upholstery and cockpit bench extension, on stb	3.390 €
XC3005	Cockpit table with teak top, electrically lowerable into sunbed incl. upholstery and cockpit bench extension, on ps	3.390 €
XC3100	Wetbar with BBQ and sink with mixing tap (only with XC9060)	5.690 €
XC4001	Gateway stanchion	990 €
XC5102	2 LEWMAR 55 EST EVO electrical halyard winches with automatic fuse (only with XH1001 or XH1005)	8.090 €
XC5200	2 LEWMAR 55 ST EVO manual secondary winches	3.490 €
XC5202	2 LEWMAR 55 EST EVO electrical secondary winches with automatic fuse (only with XH1001 or XH1005)	10.490 €
XC6005	Automatic driven fold-out for standard bathing platform with remote control and comfort stairs to the bathing platform	8.990 €
XC6008	Swimming stairs, extractable, manual (only with XC6005)	3.390 €
XC6501	Gangway, carbon, foldable with bag, 220 cm	2.990 €
XC6601	Stainless steel ladder for gateway exit, foldable (only with XC4001)	1.090 €
XC7001	Hanse Smart Tender System (only with XC6005)	8.990 €
XC7100	Air compressor for tender	890 €
XC7200	Davits, telescopic	3.790 €
XC9020	Rub rail, teak	2.590 €
XC9021	Additional stainless steel rail (only with XC9020)	2.590 €

XC9036	LED lights for side decks, integrated in toerail, white	3.490 €
XC9041	4 underwater lights below transom	4.590 €
XC9051	Electrical deck wash pump, mounted in bow area with outlet on deck	1.190 €
XC9060	2 helmsman seats, foldable (only with XC1333 or XC1334)	2.890 €
XC9171	Composite bowsprit with integrated anchor and forestay fitting with double mooring roll incl. 2nd forestay and gennaker eye	2.790 €
XC9200	Genoa tracks for 105% jib incl. cars with pin stop	1.490 €

RIG & SAILS

XE1001	Mast, anodized aluminium with manual inmast furling system	3.890 €
XE1010	Mast, anodized aluminium with electric inmast furling system (only with XH1001 or XH1005)	13.990 €
XE1102	Backstay tensioner, hydraulic	2.290 €
XE1210	Electric jib furler (only with XH1001 or XH1005)	11.490 €
XE1220	Second forestay with second furler, manual, incl. tracks (only with XC9171)	6.890 €
XE1221	Second forestay with second furler, electrical, incl. tracks (only with XH1001 or XH1005 and XC9171)	12.790 €
XE2001	Lazy bag with lazy jacks (colour selection - not with XE1001 and XE1010)	1.590 €
XE2009	Canvas windscreen with stainless steel stake (not with XE2010 or XE2012)	3.490 €
XE2010	Fixed windscreen (not with XE2009 and XE2012)	7.390 €
XE2012	Sprayhood with stainless steel stake, 3 windows (1 openable - colour selection - not with XE2009 or XE2010 or XE2051 or XE2052 or XE2053)	3.590 €
XE2013	Canvas cover connecting windscreen and composite hard top (only with XE2010 and XE2051 or XE2052 or XE2053)	3.490 €
XE2021	Bimini with stainless steel stake (colour selection - not with XE2051, XE2052 and XE2053)	4.890 €
XE2049	GRP Targa arch, gelcoat colour: White, with main sheet base (not with XE2012, XE2021 and only with XE1001 or XE1010)	14.990 €
XE2051	GRP hard top for cockpit with canvas sliding roof - outside surface, colour: White (only with XE1001 or XE1010)	26.590 €
XE2052	GRP hard top for cockpit with canvas sliding roof - outside surface painted, non metallic (colour selection - only with XE1001 or XE1010)	31.090 €
XE2053	GRP hard top for cockpit with canvas sliding roof - outside surface painted, metallic (colour selection - only with XE1001 or XE1010)	33.390 €
XE3001	QUANTUM Blue Water Dacron sails - full battened, main and jib (with XE1001 and XE1010 no battens)	2.490 €
XE3005	QUANTUM AC5 performance sails - full battened, triradial main and jib	7.390 €
XE3010	QUANTUM TP6 high - performance sails, full battened, UV protected membran, main and jib	15.290 €
XE3021	Quantum AC5 performance sail - 105% Jib with sheets (only with XC9200)	4.490 €
XE3023	QUANTUM Blue Water Dacron sail - for second forestay, vertical battens, Reacher 145% (only with XE1220 or XE1221)	3.190 €

XE3024	QUANTUM AC5 performance sails - for second forestay, vertical battens, triradial, Reacher 145% (only with XE1220 or XE1221)	8.390 €
XE3025	QUANTUM TP6 high - performance sail - for second forestay, UV protected membrane, Reacher 145% (only with XE1220 or XE1221)	16.290 €
XE9100	Spreader lights, LED, 4 up and 4 down	3.390 €

NAVIGATION & INSTRUMENTS

XF4000	B&G Zeus³S 9" chart plotter at chart table (only with Layout C2)	3.390 €
XF4500	B&G Halo 20+ Broadband Radar (only with chart plotter)	3.890 €
XF4600	B&G AIS Class B transponder (only with chart plotter and XK5000)	1.590 €
XF4650	Thermal vision camera at mast (only with Navigation Package)	6.390 €
XF4701	B&G Forward looking sonar (only with chart plotter)	1.690 €

PROPULSION

XG1003	Engine (Diesel, approx. 80 hp) - saildrive, 3-blade folding propeller	2.490 €
XG1105	Engine (Diesel, approx. 110 hp) - saildrive, 4-blade folding propeller and throttle control on instrument pod stb	14.090 €
XG3101	Bowthruster, 24 V, retractable, incl. battery	12.090 €
XG3201	Sternthruster, 24 V, retractable, incl. battery (only with XG3101)	13.690 €
XG3213	Electronic throttle control on instrument pod (helm station, stb) (not with XG1105 and only with Navigation Package)	4.390 €
XG3211	Add. electronic throttle and thruster control at helm position, on port (only with XG3213 or XG1105)	1.890 €

EQUIPMENT

XH1601	Country Version: US / JPN	3.090 €
XH2201	Inverter/charger, 12 V / 2600 W - 100 A, incl. AC panel (only with XH1001 or XH1005)	3.490 €
XH2080	Solar panel integrated in hard top (only with GRP hard top)	14.990 €
XH2101	Generator 8000i, 6,4 kW / 0 - 7,2 kVA incl. maintenance kit	19.490 €
XH2102	Generator 10000i, 8,0 kW / 0 - 9,0 kVA incl. maintenance kit	23.090 €
XH3040	Manual toilet with sea water flush - cabin layout A2	0 €
XH3021	Electric toilet with sea water flush - cabin layout B1, B2 or B3	1.690 €
XH3025	2 manual toilets with sea water flush - cabin layout B4 or B5	0 €
XH3026	2 electric toilets with sea water flush - cabin layout B4 or B5	3.390 €
XH3011	Electric toilet with sea water flush - cabin layout D1 or D2	1.690 €
XH3001	Electric toilet with sea water flush - cabin layout E2 or E3	1.690 €
XH3200	Freshwater dockside connection in cockpit	690 €

XH4011	Heating, hot air with blowers in saloon and aft head (not with XH4100)	4.590 €
XH4100	Heating, hot water ring with blowers in each cabin and head	12.590 €
XH4511	Air conditioning, 40.000 BTU, 3 units: saloon, fwd cabin, aft cabin, incl. 2nd shore power	21.990 €
XH4513	Air conditioning, 8.000 BTU, for crew cabin, (only with XH4511 and XL1002)	6.290 €
XH4514	Air conditioning, 8.000 BTU, for E4 layout, (only with XH4511 and XL5004)	6.290 €
XH5020	Water maker, 12 V, 60 l / h (only with A1 layout and XH1001 or XH1005)	16.790 €
XH5100	Additional fridge in galley (not with XH5121 and XH5210 - only with XH1001 or XH1005)	1.690 €
XH5101	Additional fridge in cockpit on ps	1.690 €
XH5110	Double fridge 140 l in galley (only with C1 layout and XH1001 or XH1005)	2.190 €
XH5112	Wine cooler in galley (only with XH1001 or XH1005)	2.190 €
XH5120	Additional freezer in utility room (only with E1 layout and XH1001 or XH1005)	1.690 €
XH5121	Additional freezer in galley (not with XH5100 and XH5210 - only with XH1001 or XH1005)	1.690 €
XH5150	Microwave in galley	1.790 €
XH5210	Dishwasher in galley (not with XH5100 and XH5121 - only with XH1001 or XH1005)	1.990 €
XH5311	Washing machine with dryer function, front opening, in utility room (only with cabin layout E1)	3.490 €
XH6001	Grey water system for bathrooms and galley, tank: 175 l (not with XH6011)	3.490 €
XH6011	Add. fresh water tank, appr. 175 l (not with XH6001)	3.390 €
XH6021	Add. fuel tank, appr. 175 l	3.590 €

RADIO & ENTERTAINMENT

XK5000	VHF preparation with antenna and splitter for FM and AIS	490 €
XK5011	Antenna for 3G/4G internet and Wi-Fi onboard	1.390 €

ACCESSORIES

XV9120	Cover for cockpit table (colour selection)	890 €
XV9130	Cover for steering wheels (colour selection)	590 €
XV9380	Shrink wrap foil (for storage purpose only / not for transport) (not with XA1002, XA1003, XE2051, XE2052, XE2053, XE2010)	890 €

SHIPPING & TRANSPORT

XZ2001	Loading on truck	790 €
XZ2003	Oversea shipping pack (cradle)	3.790 €
XZ2020	Ready for Pickup	690 €

All mentioned prices in €, basic prices ex yard and excl. VAT. All weights and measures are calculated numbers based on the construction data. Changes in construction and equipment reserved. Above mentioned prices are recommended for ex yard deliveries within 4 month after order confirmation. For later delivery time the company reserves right to apply latest price list. Company reserves additional 15 working days when painted hull or deck is ordered. All measurements/figures are approximate. Errors and omissions excepted. Specification and material can be changed without notice. Valid from 2022.09.02.