

PRICELIST & SPECIFICATION

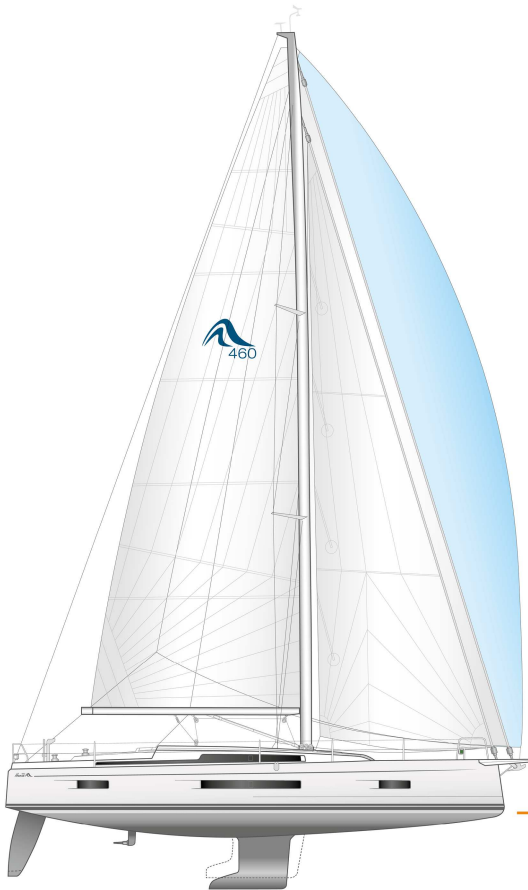

LOA		14.60 m	47' 11"
Hull length		13.87 m	45' 6"
LWL		13.05 m	42' 10"
Beam		4.79 m	15' 9"
Draft			
shallow keel		1.75 m	5' 9"
L-keel, medium		2.25 m	7' 5"
Displacement			
shallow keel	approx.	13.00 t	28,660 lbs
L-keel, medium	approx.	12.60 t	27,778 lbs
Engine Diesel			
standard	approx.	57 PS	57 hp
option	approx.	80 PS	80 hp
Fuel tank	approx.	200 l	53 gal
Fresh water	approx.	450 l	119 gal
CE Certificate		A - 12	
Design		Berret - Racoupeau	
Interior		Berret - Racoupeau	

Mast length above WL	approx.	21.90 m	71' 10"
Upwind sail area	approx.	114.00 m ²	1,227 sq ft
Downwind sail area	approx.	234.00 m ²	2,519 sq ft
Main sail	approx.	64.00 m ²	689 sq ft
Jib	approx.	42.00 m ²	452 sq ft
Genoa	approx.	50.00 m ²	538 sq ft
Reacher	approx.	78.00 m ²	840 sq ft
Gennaker	approx.	170.00 m ²	1,830 sq ft

460

All measurements/figures are approximate. Errors and omissions excepted. Specification and material can be changed without notice. Valid from 2022.11.07.

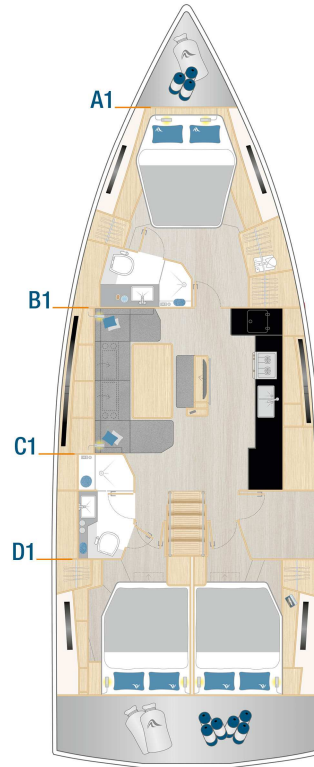

Standard

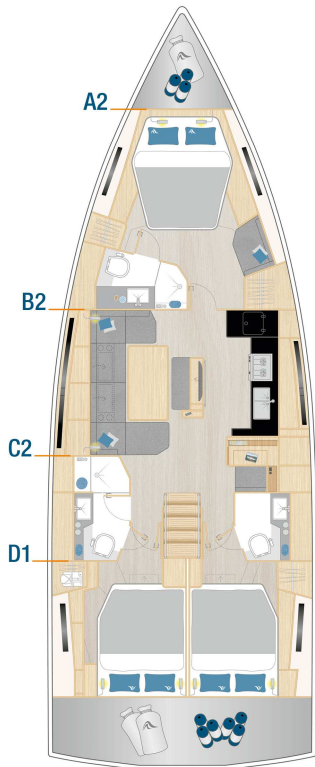

Option

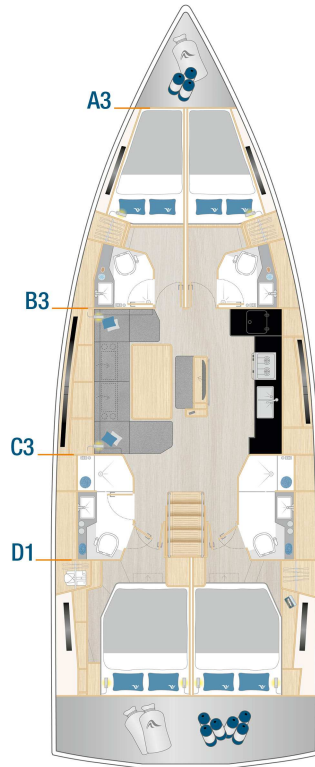

Option

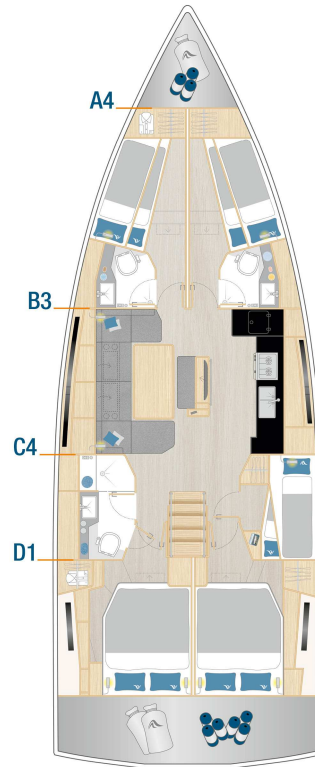

Option

HULL

- 8 hull windows (4 each side)
- GRP hull, isophthalic gelcoat, colour: Signal White (RAL 9003), 1st layer vinyl ester resin and balsa sandwich laminat
- Waterline and cove line, isophthalic gelcoat, colour: Dark Grey (RAL 7043)

KEEL

- L-keel, cast iron, draft: 2.25 m
- GRP rudder with sea-water resistant aluminium shaft and selfaligning bearings

LAYOUT & INTERIOR

- A1: Master cabin with island double berth, 1 locker and 1 big locker and ensuite head with separate shower stall
- B1: Saloon with full functional large L-galley on stb and dining area with bar on port (only with C1 or C2 layout)
- C1: Head with separate shower stall and dayhead door on port and storage room on stb (not with B3 layout)
- D1: 2 aft cabins with VIP cabin on port incl. "Queen size" bed and guest cabin on stb with double berth and storage space
- 3-burner gas stove with oven, waste bin, 12 V fridge approx. 135 l, double stainless steel sink with mixing tab
- Interior furniture in high quality marine plywood, Satin Varnish
- Hanse companionway closing system
- Saloon table, fixed
- Worktop in galley and heads - Black Quartz

WOOD (FURNITURE, FLOORBOARD)

- Furniture - Mahogany Style, Satin Varnish
- Galley cupboard fronts in wood colour
- Floorboard - Acacia

UPHOLSTERY

- Mattresses for all berths
- Upholstery - Monte Carlo, colour: Cream

DECK & OUTSIDE EQUIPMENT

- GRP deck with antislip surface, isophthalic gelcoat, colour: Signal White (RAL 9003), 1st layer vinyl ester resin with balsa sandwich core. 2 cockpit lockers, 1 space for life raft, stern locker on port, stowage for running rigging at helm position, anchor locker at bow.

- Twin wheel steering system with emergency tiller
- 2 stainless steel steering wheels with leather cover
- Cockpit table, stainless steel with teak tops, on stb
- Cockpit table, stainless steel with teak tops, on ps
- Pulpit and pushpit, stainless steel
- Railing, incl. stanchions and stainless steel wire
- Covered halyards and control lines lead to cockpit helmposition, organizers and jammers, 4 mooring cleats, handrails on coach roof
- 2 LEWMAR 45 ST EVO manual halyard winches
- Bathing platform, manual fold-out with swimming ladder
- Composite bowsprit with integrated anchor and forestay fitting
- Self tacking jib system
- Mainsheet system
- 8 large and 6 small deck hatches - openable, anchor locker hatch
- 4 large coach roof side windows - openable, 4 portlights in coach roof

RIG & SAILS

- Rig, anodized aluminium, deck stepped, with kicker, standing and running rigging and 2 reefs
- Backstay tensioner, manual
- Manual jib furler
- QUANTUM Dacron sails - full battened, main and jib

NAVIGATION & INSTRUMENTS

- Illuminated compass at each helm
- Navigation lights - LED

PROPULSION

- Fuel tank, approx. 200 l
- Engine (Diesel, approx. 57 hp) - saildrive, 3-blade fix propeller
- Throttle control at helm position, stb

EQUIPMENT

- 12 V and 230 V electric system with main panels and 230 V shore power and sockets in cabins and heads
- AGM battery set, capacity: 1x 90 Ah + 1x 160 Ah AGM
- Country Version: EU / AUS
- Battery charger 35 A
- Manual toilet with sea water flush - cabin layout A1 or A2

- Manual toilet with sea water flush - cabin layout C1 or C4
- LPG gas system, stowage for 1 gas bottle
- Black water system (appr. 85 l each bathroom) with deck extraction and seacock for head, electric and manual bilge pump
- Fresh water system with electric pump and 40 l hot water, heated also by main engine
- Fresh water tank, appr. 450 l

SHIPPING & TRANSPORT

- CE - Certificate cat. A - 12, B - 14, C - 16
- Owners manual
- EC - Type Examination Certificate

AS PER STANDARD SPECIFICATION

excl. VAT
284.900 €

PACKAGES

XW2000	B&G Navigation Package	14.490 €
XF2000	2 instrument pods (1 per helm station)	
XF2200	2 B&G Triton ² multifunction displays, 1 per helm station, incl. transducer (wind/depth/speed/temperature)	
XF3000	B&G VHF V60 at chart table, incl. wireless remote handset H60 (only with XK5000)	
XF4030	B&G Zeus ³ S 9" chart plotter at helm station, stb	
XF5000	B&G Autopilot with Triton ² control unit with WR10 remote control and Precision 9 compass	
XH2090	Wireless charging at helm station (waterproof)	
XK5000	VHF preparation with antenna and splitter for FM and AIS	
<hr/>		
XW2001	Upgrade - second chart plotter	2.490 €
XF4031	B&G Zeus ³ S 9" chart plotter at helm station, ps	
<hr/>		
XW2002	Upgrade - 12" chart plotter	4.790 €
XF4040	B&G Zeus ³ S 12" chart plotter at helm station, stb	
XF4041	B&G Zeus ³ S 12" chart plotter at helm station, ps	
<hr/>		
XW3000	Cruising Package	8.890 €
XC1325	Teak on cockpit bottom	
XC1340	Teak on cockpit benches	
XC1350	Teak on bathing platform	
XC9062	Helmsman footrests (free mountable)	
XC9080	2 additional cleats, midship (1 each side)	
XC9090	Anchor windlass, electrical, 1000 W, automatic fuse, remote control	
XC9100	Delta-anchor 20 kg, galvanized with 60 m galvanized chain	
XC9402	Cockpit portlight, aft cabins	
XF4550	MyHanse Safety Cloud with 24 months subscription and device installed on board	
XH1001	Battery set, capacity: 1x 90 Ah + 2x 160 Ah AGM	
XH1110	Deep charge protection for service batteries	
XH3110	Shower unit in cockpit, warm-/coldwater	
XH5030	Water akku for pressure equalization	

XV9420 Wind indicator

XV9450 Flagpole

XV9901 6 fenders

XV9902 4 mooring lines

XV9910 Add. winch handle

XV9920 Mast steps

XV9950 Hanse maintenance kit

XW3001 Upgrade - Flexiteek (colour selection)

890 €

XC1326 Flexiteek on cockpit bottom

XC1341 Flexiteek on cockpit benches

XC1351 Flexiteek on bathing platform

XW3002 Upgrade - stainless steel anchor with chain

4.090 €

XC9101 Delta-anchor 20 kg, stainless steel, with 'Ultra swiffel' swivel and 100 m stainless steel chain

XW3003 Upgrade - Anchor windlass 1500 W

1.790 €

XC9088 Combined mooring/anchor windlass, electrical, 1500 W, automatic fuse, remote control with chain counter (only with XH1001 or XH1005)

XW3004 Upgrade - Battery set Lithium-Ion

8.390 €

XH1005 Battery set, capacity: 1x 90 Ah + 6x 105 Ah Li-Ion

XW3005 Upgrade - 4 enlarged cleats

3.390 €

XC9081 4 enlarged cleats - bow and stern, retractable and 4 standard size cleats, retractable - midship (2 each side)

XW3006 Upgrade - MyHanse Safety Cloud extention

3.890 €

XF4655 Interior camera

XH5409 Gas leak detector

XK5031 WLAN router

XL9005 Light in navigation area, switchable by APP

XW4000 Performance Package

7.890 €

XC2201 2 GRP steering wheels, Y-spoke (black or white)

XE3005 QUANTUM AC5 performance sails - full battened, triradial main and jib

XE9001 Dyneema halyards for main and jib

XE9002 Selden MDS mainsail slider system

XW4100 Gennaker Package

6.890 €

XE3100 QUANTUM Gennaker (colour selection - only with XC9171)

XE3110 Squeezer for Gennaker

XE9003 Gennaker package incl. halyard, 2 sheets, 2 blocks and padeyes (only with XC9171)

XW5000 Comfort Package

6.290 €

XC9032 Courtesy lights in cockpit

XC9033 Courtesy lights at companionway

XC9300 2 vents for coach roof hatches

XL9001 Courtesy lights in saloon

XL9003 Indirect lights in saloon and cabins

XL9004 LED overhead lights in saloon and cabins, dimmable

XL9010 SLS - Scenario light system - touch screen controller and dimmer in saloon and fwd cabin

XN2500 Cockpit cushions (colour selection)

XV9010 Blind set with flyscreens for deck hatches

XV9060 Blinds for hull windows

XV9080 Blinds for side coach roof windows

XW6000 Flagship Package

8.890 €

XL7410 Leather covered handrails

XL7420 Soft material covered bulkheads in the saloon

XN2055 Luxury upholstery with multifunction backrests

XW7000 FUSION Entertainment Package - Saloon

3.590 €

XK1000 FUSION APOLLO MS-RA770 Multimedia radio with Wi-Fi and touchscreen - for saloon and cockpit (only with XK5000)

XK1200 Subwoofer with integrated amplifier in saloon

XK2040 4 high-end 2-way speakers in saloon

XK2070 2 high-end 2-way speakers in cockpit

XK3000 FUSION MS-ERX400 remote control in cockpit

XK5030 FUSION wireless link - remote control via mobile devices

XW7001	FUSION Entertainment Package - Master cabin (only with A2 layout)	3.690 €
XK1010	FUSION APOLLO MS-RA770 Multimedia radio with Wi-Fi and touchscreen - for master cabin (only with XK5000)	
XK2010	2 high-end 2-way speakers in master cabin	
XK4110	LED TV flat screen in master cabin	

XW7010	JL Entertainment Package - Saloon	7.190 €
XK1001	JL Media Master MM50 with Bluetooth - for saloon and cockpit (only with XK5000)	
XK2041	4 JL Audio speakers in saloon	
XK2071	2 JL Audio speakers in cockpit	
XK3001	JL Audio MMR-40 remote control in cockpit	

XW7011	JL Entertainment Package - Master cabin (only with A2 layout)	4.490 €
XK1011	JL Media Master MM50 with Bluetooth - for master cabin (only with XK5000)	
XK2011	2 JL Audio speakers in master cabin	
XK4110	LED TV flat screen in master cabin	

XW7030	TV Package - Saloon	4.490 €
XK4100	LED TV flat screen in saloon	
XK4240	TV lifting system in saloon	
XK5020	DVB-T2 antenna for TV	

OPTIONS

excl. VAT

HULL

XA1001	GRP hull, gelcoat colour: Grey (RAL 7040)	5.190 €
XA1002	GRP hull, painted, non metallic (colour selection)	23.090 €
XA1003	GRP hull, painted, metallic (colour selection)	30.390 €
XA3001	Waterline and cove line, coloured gelcoat (colour selection - only with XA1000 or XA1001)	790 €
XA3002	Waterline and cove line, painted, non metallic (colour selection - only with XA1002 or XA1003)	890 €
XA3003	Waterline and cove line, painted, metallic (colour selection - only with XA1002 or XA1003)	1.090 €

KEEL

XB1001	L-keel, cast iron, draft: 1,75 m	3.690 €
XB9000	Keel and rudder - not mounted	890 €

LAYOUT & INTERIOR

XL1002	A2: Master cabin with island double berth, 2 lockers, seating area and ensuite head with separate shower stall	890 €
XL1003	A3: 2 fwd cabins with double berth, storage space and separate heads	4.990 €
XL1004	A4: 2 fwd cabins with bunk berth, storage space and separate heads	5.190 €
XL2002	B2: Saloon with full functional U-galley and chart table on stb and dining area with bar on port (only with C1 or C2 layout)	3.290 €
XL2003	B3: Saloon with full functional L-galley on stb and dining area with bar on port (only with C3 or C4 layout)	890 €
XL3002	C2: Head with separate shower stall on port and head on stb (not with B3 layout)	1.690 €
XL3003	C3: 2 heads with separate shower stall on port and stb (only with B3 layout)	3.190 €
XL3004	C4: Head with separate shower stall and dayhead door on port and cabin with double bunkbed on stb (only with B3 layout)	1.690 €
XL6010	Converted utility room in C1 layout	1.990 €
XL6050	Day head door for head in saloon on port side (not with C1 and C4 layout)	1.090 €
XL7001	Saloon table electrically lowerable with cushions, convertible into double berth	2.790 €
XL7601	Worktop in galley and heads - Off White	890 €
XL7602	Worktop and sink of the galley in Marine Mineral Stone (colour selection)	2.990 €

WOOD (FURNITURE, FLOORBOARD)

XM1102	Furniture - Teak	5.690 €
XM1103	Furniture - Canadian Chestnut	5.690 €
XM1104	Furniture - French Oak	5.690 €
XM1161	Galley cupboard fronts coloured (partial as per design - colour selection)	2.090 €
XM1201	Floorboard - Classic Stripes	2.090 €
XM1202	Floorboard - Noce Nero	1.090 €
XM1203	Floorboard - Delight Oak	1.090 €
XM9000	Floorboard - wooden grating in all heads and showers	1.690 €

UPHOLSTERY

XN1100	Comfort mattresses for all berths (excluded A4 and C4 layout)	3.390 €
XN2001	Upholstery - Sorrento (colour selection)	1.090 €
XN2002	Upholstery - Florence (colour selection)	1.590 €
XN2003	Upholstery - Monaco (colour selection)	1.890 €
XN2004	Upholstery - Portofino Leather (colour selection)	4.490 €
XN2400	Sun bed cushions on coach roof (colour selection)	2.090 €

XN2503	Cushion for helmsman seats (colour selection - only with XC9060)	690 €
XN2505	Cushion for wetbar (colour selection - only with XC3100)	490 €

DECK & OUTSIDE EQUIPMENT

XC1300	Teak on side deck	17.290 €
XC1301	Flexiteek on side deck (colour selection)	18.390 €
XC1310	Teak on coach roof	5.890 €
XC1311	Flexiteek on coach roof (colour selection)	7.390 €
XC1333	Teak on helmsman seats (only with XC9060)	990 €
XC1334	Flexiteek on helmsman seats (colour selection - only with XC9060)	1.090 €
XC2201	2 GRP steering wheels, Y-spoke (black or white)	1.790 €
XC3004	Cockpit table with teak top, electrically lowerable into sunbed incl. upholstery and cockpit bench extension, on stb	3.290 €
XC3005	Cockpit table with teak top, electrically lowerable into sunbed incl. upholstery, on ps	2.190 €
XC3100	Wetbar with BBQ and sink with mixing tab (only with XC9060)	5.090 €
XC4001	Gateway stanchion	990 €
XC5102	2 LEWMAR 50 EST EVO electrical halyard winches with automatic fuse (only with XH1001 or XH1005)	7.790 €
XC5200	2 LEWMAR 45 ST EVO manual secondary winches	2.690 €
XC5202	2 LEWMAR 50 EST EVO electrical secondary winches with automatic fuse (only with XH1001 or XH1005)	7.890 €
XC6005	Automatic fold-out for standard bathing platform with remote control	3.390 €
XC6150	Bathing platform, automatic fold-out, remote control and swimming stairs	5.590 €
XC6501	Gangway, carbon, foldable with bag, 220 cm	2.990 €
XC6601	Stainless steel ladder for gateway exit, foldable (only with XC4001)	1.090 €
XC7100	Air compressor for tender	890 €
XC7200	Davits, telescopic	3.790 €
XC9020	Rub rail, teak	2.190 €
XC9021	Additional stainless steel rail (only with XC9020)	2.190 €
XC9041	4 underwater lights below transom	4.590 €
XC9051	Electrical deck wash pump, mounted in bow area with outlet on deck	1.190 €
XC9060	2 helmsman seats, foldable (only with XC1333 or XC1334)	2.690 €
XC9171	Composite bowsprit with integrated anchor and forestay fitting with double mooring roll incl. 2nd forestay and gennaker eye	1.490 €
XC9200	Genoa tracks for 105% jib incl. cars with pin stop	1.490 €

RIG & SAILS

XE1001	Mast, anodized aluminium with manual inmast furling system	3.390 €
XE1010	Mast, anodized aluminium with electric inmast furling system (only with XH1001 or XH1005)	12.590 €
XE1102	Backstay tensioner, hydraulic	2.290 €
XE1210	Electric jib furler (only with XH1001 or XH1005)	11.390 €
XE1220	Second forestay with second furler, manual, incl. tracks (only with XC9171)	6.690 €
XE1221	Second forestay with second furler, electrical, incl. tracks (only with XH1001 or XH1005 and XC9171)	12.590 €
XE2001	Lazy bag with lazy jacks (colour selection - not with XE1001 and XE1010)	1.290 €
XE2009	Canvas windscreen with stainless steel stake (not with XE2012)	3.090 €
XE2010	Fixed windscreen integrated in GRP hard top (only with GRP hard top)	7.390 €
XE2012	Sprayhood with stainless steel stake, 3 windows (1 openable - colour selection - not with XE2009 or XE2010 or XE2051 or XE2052 or XE2053)	3.390 €
XE2013	Canvas cover connecting windscreen and composite hard top (only with XE2010 and XE2051 or XE2052 or XE2053)	3.490 €
XE2021	Bimini with stainless steel stake (colour selection - not with XE2051, XE2052 and XE2053)	4.490 €
XE2049	GRP Targa arch, gelcoat colour: White, with main sheet base (not with XE2012, XE2021 and only with XE1001 or XE1010)	13.590 €
XE2051	GRP hard top for cockpit with canvas sliding roof - outside surface, colour: White (only with XE1001 or XE1010)	26.190 €
XE2052	GRP hard top for cockpit with canvas sliding roof - outside surface painted, non metallic (colour selection - only with XE1001 or XE1010)	30.390 €
XE2053	GRP hard top for cockpit with canvas sliding roof - outside surface painted, metallic (colour selection - only with XE1001 or XE1010)	32.490 €
XE2060	T-Top not mounted	1.090 €
XE3001	QUANTUM Blue Water Dacron sails - full battened, main and jib (with XE1001 and XE1010 no battens)	2.090 €
XE3005	QUANTUM AC5 performance sails - full battened, triradial main and jib	6.290 €
XE3021	QUANTUM AC5 performance sail - 105% Jib with sheets (only with XC9200)	4.190 €
XE3023	QUANTUM Blue Water Dacron sail - for second forestay, vertical battens, Reacher 145% (only with XE1220 or XE1221)	2.990 €
XE3024	QUANTUM AC5 performance sails - for second forestay, vertical battens, triradial, Reacher 145% (only with XE1220 or XE1221)	7.890 €
XE9001	Dyneema halyards for main and jib	1.290 €
XE9100	Spreader lights, LED, 4 up and 4 down	3.390 €

NAVIGATION & INSTRUMENTS

XF4000	B&G Zeus®S 9" chart plotter at chart table	3.390 €
XF4500	B&G Halo 20+ Broadband Radar (only with chart plotter)	3.890 €
XF4600	B&G AIS Class B transponder (only with chart plotter and XK5000)	1.590 €
XF4650	Thermal vision camera at mast (only with Navigation Package)	6.390 €
XF4701	B&G Forward looking sonar (only with chart plotter)	1.690 €

PROPULSION

XG1003	Engine (Diesel, approx. 57 hp) - saildrive, 3-blade folding propeller	1.990 €
XG1103	Engine (Diesel, approx. 80 hp) - saildrive, 3-blade folding propeller	6.790 €
XG3101	Bowthruster, 24 V, retractable, incl. battery	10.990 €
XG3201	Sternthruster, 24 V, retractable, incl. battery (only with XG3101)	13.690 €
XG3213	Throttle control on instrument pod (helm station, stb)	4.390 €
XG3211	Add. electronic throttle and thruster control at helm position, on port (only with XG3213)	1.890 €

EQUIPMENT

XH1601	Country Version: US / JPN	2.690 €
XH2080	Solar panel integrated in hard top (only with GRP hard top)	13.090 €
XH2101	Generator 8000i, 6,4 kW / 0 - 7,2 kVA incl. maintenance kit	19.490 €
XH2102	Generator 10000i, 8,0 kW / 0 - 9,0 kVA incl. maintenance kit	23.090 €
XH2201	Inverter/charger, 12 V / 2600 W - 100 A, incl. AC panel (only with XH1001 or XH1005)	3.490 €
XH3011	Electric toilet with sea water flush - cabin layout A1 or A2	1.690 €
XH3013	2 electric toilets with sea water flush - cabin layout A3 or A4	3.390 €
XH3001	Electric toilet with sea water flush - cabin layout C1 or C4	1.690 €
XH3003	2 electric toilets with sea water flush - cabin layout C2 or C3	3.390 €
XH3200	Freshwater dockside connection in cockpit	690 €
XH4011	Heating, hot air with blowers in saloon and aft head (not with XH4100)	4.590 €
XH4100	Heating, hot water ring with blowers in each cabin and head	10.290 €
XH4511	Air conditioning, 28.000 BTU, 3 units: saloon, fwd cabin, aft cabin, incl. 2nd shore power	17.790 €
XH5020	Water maker, 12 V, 60 l / h (only with XH1001 or XH1005)	16.790 €
XH5100	Additional fridge in galley (not with XH5121 and XH5210 - only with XH1001 or XH1005)	1.690 €
XH5101	Additional fridge in cockpit on ps	1.690 €
XH5110	Double fridge 140 l in galley (only with B1 layout and XH1001 or XH1005)	2.190 €
XH5112	Wine cooler in galley (only with XH1001 or XH1005)	2.190 €

XH5120	Additional freezer in utility room (only with C1 layout and XH1001 or XH1005)	1.690 €
XH5121	Additional freezer in galley (not with XH5100 and XH5210 - only with XH1001 or XH1005)	1.690 €
XH5150	Microwave in galley	1.790 €
XH5210	Dishwasher in galley (not with XH5100 and XH5121 - only with XH1001 or XH1005)	1.990 €
XH5311	Washing machine with dryer function, front opening, in utility room - cabin layout C1	3.490 €
XH6001	Grey water system for bathrooms and galley, tank: 175 l	3.490 €

RADIO & ENTERTAINMENT

XK5000	VHF preparation with antenna and splitter for FM and AIS	490 €
--------	--	--------------

ACCESSORIES

XV9120	Cover for cockpit table (colour selection)	890 €
XV9130	Cover for steering wheels (colour selection)	590 €
XV9380	Shrink wrap foil (for storage purpose only / not for transport) (not with XA1002, XA1003, XE2051, XE2052, XE2053, XE2010)	790 €

SHIPPING & TRANSPORT

XZ2001	Loading on truck	690 €
XZ2003	Oversea shipping pack (cradle)	3.390 €
XZ2020	Ready for Pickup	690 €

All mentioned prices in €, basic prices ex yard and excl. VAT. All weights and measures are calculated numbers based on the construction data. Changes in construction and equipment reserved.
 Above mentioned prices are recommended for ex yard deliveries within 4 month after order confirmation. For later delivery time the company reserves right to apply latest price list. Company reserves additional 15 working days when painted hull or deck is ordered. All measurements/figures are approximate. Errors and omissions excepted. Specification and material can be changed without notice.
 Valid from 2022.11.07.