

SPECIFICATION & PRICELIST

Dehler  **46 SQ**



TECHNICAL DATA

LOA 14.94 m / 49' 0"

HULL LENGTH 13.95 m / 45' 9"

LWL 12.90 m / 42' 4"

BEAM 4.35 m / 14' 3"

DRAUGHT (DWL)

standard 2.25 m / 7' 5"

competition 2.58 m / 8' 6"

L-keel deep 2.48 m / 8' 2"

shallow keel 1.85 m / 7' 1"

BALLAST

standard 3.50 t / 7,716 lbs

competition 3.15 t / 6,944 lbs

L-keel deep 3.35 t / 7,385 lbs

shallow keel 3.85 t / 8,488 lbs

DISPLACEMENT

standard 11.50 t / 25,353 lbs

competition 11.20 t / 24,691 lbs

L-keel deep 11.40 t / 25,132 lbs

shallow keel 11.90 t / 26,235 lbs

ENGINE APPROX.

Diesel 57 PS / hp

FRESH WATER

approx. 450 l / 119.00 gal

FUEL TANK

approx. 200 l / 53.00 gal

MAST ABOVE WL

standard 21.23 m / 69' 8"

competition 22.20 m / 72' 1"

TOTAL SAIL AREA

standard 116.73 m² / 1,256 sq ft

competition 126.79 m² / 1,365 sq ft

MAIN SAIL

standard 64.10 m² / 690 sq ft

competition 70.52 m² / 759 sq ft

FURLING JIB 105%

standard 52.63 m² / 567 sq ft

competition 56.27 m² / 606 sq ft

SPINNAKER

competition 150.00 m² / 1,615 sq ft

GENNAKER

standard 185.38 m² / 1,995 sq ft

competition 214.00 m² / 2,303 sq ft

FREERIDE

standard 120.38 m² / 1,296 sq ft

competition 128.50 m² / 1,383 sq ft

RIG

standard I 18.10 m / 59' 5"

J 5.50 m / 18' 1"

P 17.68 m / 58' 0"

E 6.25 m / 20' 6"

competition

I 18.90 m / 62' 0"

J 5.50 m / 18' 1"

P 18.70 m / 61' 4"

E 6.55 m / 21' 6"

CE CERTIFICATE

Class A

DESIGN

judel/vrolijk & co.

INTERIOR

Dehler

All measurements/figures are approximate. Errors and omissions excepted. Specification and material can be changed without notice. Valid from 2023.01.01 for deliveries until 2023.12.31.

DECK AND INTERIOR LAYOUTS

Dehler  **46 SQ**

DECK LAYOUT

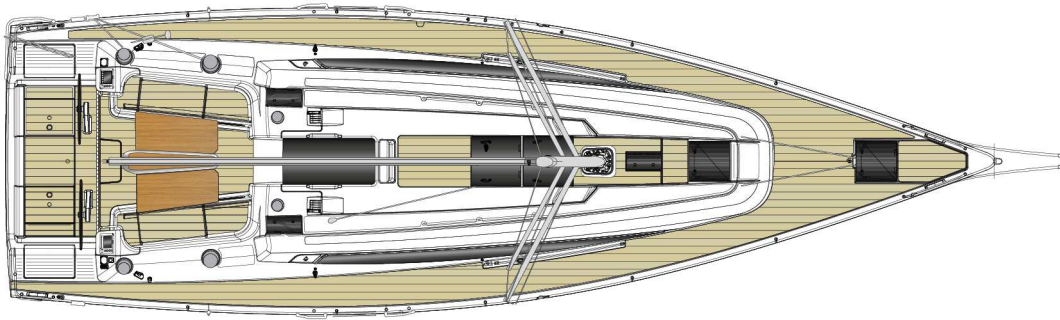

INTERIOR LAYOUT

STANDARD

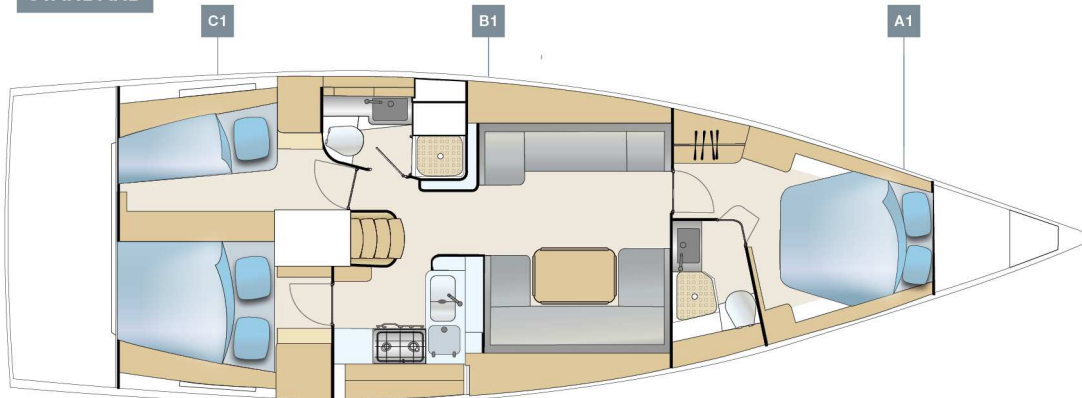

OPTION

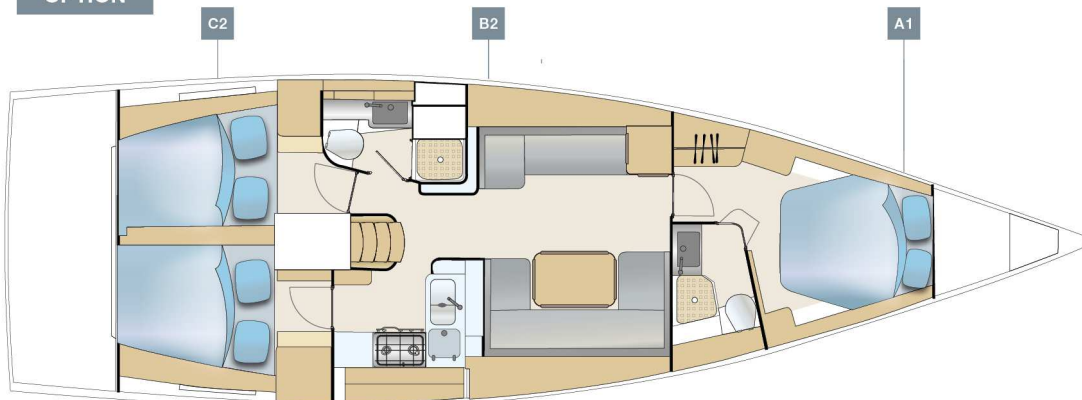

DECK AND INTERIOR LAYOUTS

Dehler  **46 SQ**

INTERIOR LAYOUT

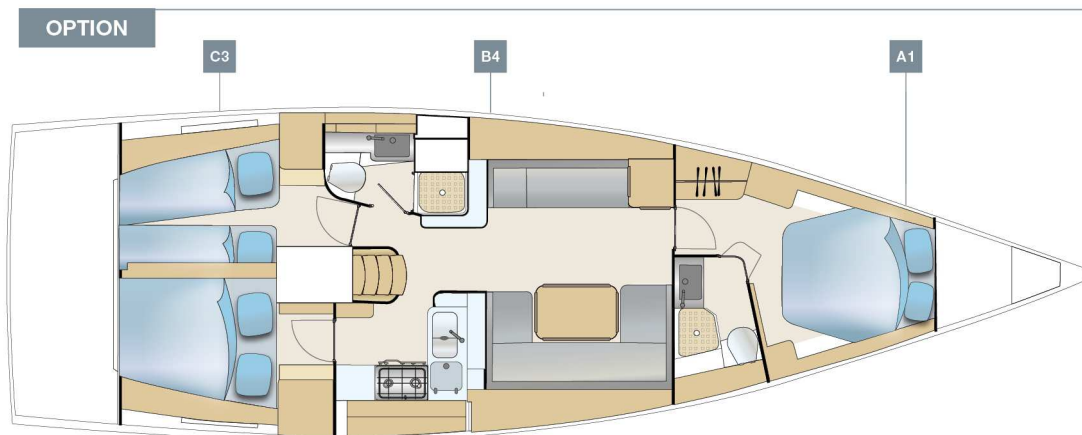
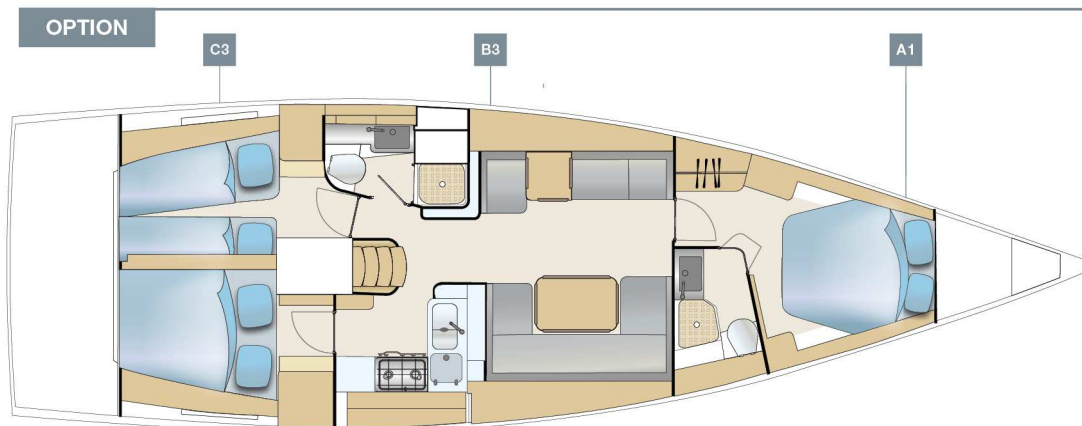

HULL

- 6 hull windows (3 each side)
- GRP hull, isophthalic gelcoat, colour: Signal White (RAL 9003), 1st layer vinylester resin with PVC foam core built in vacuum infusion
- Waterline and cove line, isophthalic gelcoat, colour: Dark Blue (RAL 5004)

KEEL

- L-keel, cast iron, draft: 2.25 m
- GRP rudder with sea-water resistant aluminium shaft and selfaligning bearings

LAYOUT & INTERIOR

- A1: Master cabin with island double berth, storage space and a head with separate shower stall
- B1: Saloon with L-galley, dining area on stb, long sofa and head with separate shower stall on port
- C1: 2 aft cabins: single berth with locker and storage on port and double berth with locker and storage on stb
- 3-burner gas stove, waste bin, 12 V fridge approx. 130 l, double stainless steel sink with mixing tap
- Interior furniture in high quality marine plywood, satin varnish
- Dehler companionway closing system
- Saloon table, folding with stowage
- Worktop in galley, Off White
- Indirect lights in saloon
- SLS - Scenario light system - touch screen controller and dimmer in saloon and master cabin

WOOD (FURNITURE, FLOORBOARD)

- Furniture - Mahogany
- Floorboard - Australian Acacia

UPHOLSTERY

- Mattresses for all berths
- Upholstery - Baltic, colour: creme
- Upholstery - Piping (colour selection)

DECK & OUTSIDE EQUIPMENT

- GRP deck with antislip surface, isophthalic gelcoat, colour: Signal White (RAL 9003), 1st layer vinyl ester resin with balsa sandwich core.
- Cockpit lockers, stern lockers on port and stb, anchor locker at bow.
- Cockpit bottom, gelcoat colour: Signal White (RAL 9003)
- Teak on coach roof
- Teak on cockpit benches
- Twin wheel steering system with emergency tiller
- 2 stainless steel steering wheels with leather cover
- Pulpit and pushpit, stainless steel
- Railing, incl. stanchions and stainless steel wire
- Halyards and control lines with organizers and jammers on coach roof, 4 retractable mooring cleats, handrails on coach roof
- 2 LEWMAR 50 Race manual halyard winches
- 2 LEWMAR 50 Race manual secondary winches
- 2 LEWMAR 50 Race manual mainsheet winches
- Swimming ladder

- Rub rail, aluminium
- LED backlighting design part on the coach roof
- Helmsman footrests, foldable
- Anchor windlass, electrical with automatic fuse
- Composite bowsprit with integrated anchor fitting
- Genoa tracks, incl. cars, adjustable from cockpit
- German mainsheet system with adjustable traveller
- 6 deck hatches - openable, anchor locker hatch
- 8 deck coach roof windows - openable, portlights in cockpit sides for aft cabins

RIG & SAILS

- Rig, anodized aluminium, keel stepped incl.: dyform rigging, running rigging, kicker, manual jib flat deck furler, "Dehler Quick Reefing System", hydraulic backstay tensioner
- QUANTUM AC5 performance sails - full battened, triradial, main and jib
- Dyneema halyards for main and jib

NAVIGATION & INSTRUMENTS

- 2 illuminated compasses at steering pedestal
- Navigation lights - LED

PROPULSION

- Fuel tank, approx. 200 l
- Engine (Diesel, approx. 57 hp) - saildrive, 3 blade folding propeller

EQUIPMENT

- 12 V and 230 V electric system with main panel, 12 V and 230 V socket and 230 V shore power
- AGM battery set - capacity: Starter battery: 1 x 90 Ah, service battery: 1 x 160 Ah
- Country Version: EU / AUS
- Battery charger 35 A
- Manual toilet with sea water flush - cabin layout B
- Manual toilet with sea water flush - cabin layout A
- Shower unit in cockpit, warm-/coldwater
- LPG gas system, stowage for 1 bottle
- Manual and electric bilge pump
- Black water system (appr. 85 l) with deck extraction and seacock for aft head, appr. 35 l in fwd head
- Fresh water system with electric pump and 20 l hotwater, heated also by main engine
- Fresh water tank, appr. 450 l

SHIPPING & TRANSPORT

- CE - Certificate cat. A
- Owners manual
- EC - Type Examination Certificate

AS PER STANDARD SPECIFICATION

excl. VAT
384.900 €

PACKAGES

| | | |
|---------------|---|-----------------|
| XW2010 | B&G Navigation Package - Cruising | 14.390 € |
| XF2005 | Instrument pod on helm station stb | |
| XF2210 | 2 B&G Triton ² multifunction displays, 1 per helm station, incl. transducer (wind/depth/speed/temperature) | |
| XF3000 | B&G VHF V60 at chart table, incl. wireless remote handset H60 (only with XK5000) | |
| XF4040 | B&G Zeus ^S 9" chart plotter, stb helm station | |
| XF5000 | B&G Autopilot with Triton ² control unit with WR10 remote control and Precision 9 compass | |
| XK5000 | VHF preparation with antenna and splitter for FM and AIS | |
| XW2011 | Upgrade - Competition | 6.290 € |
| XF2211 | 2 B&G H5000 multifunction displays, 1 per helm station, incl. transducer (depth/speed/temperature) and wind sensor at vertical carbon mast unit | |
| XF5001 | B&G Autopilot with H5000 control unit with WR10 remote control and Precision 9 compass | |
| XF5200 | B&G CPU Hydra computer (only with B&G H5000 instrument) | |
| XW2012 | Upgrade - second chart plotter | 3.090 € |
| XF2010 | Instrument pod on helm station ps | |
| XF4041 | B&G Zeus ^S 9" chart plotter, ps helm station | |
| XW2013 | Upgrade - mast display | 4.090 € |
| XF2240 | B&G Nemesis 9" multifunction display at mast | |
| XW3100 | Cruising Package | 14.490 € |
| XC1325 | Teak on cockpit bottom | |
| XC1350 | Teak on bathing platform | |
| XC6001 | Bathing platform, manual fold-out with swimming ladder | |
| XC9032 | Courtesy lights in cockpit | |
| XC9070 | Halyard bags | |
| XC9080 | 2 add. cleats, midship, retractable (1 each side) | |
| XC9100 | Delta-anchor 20 kg, galvanized with 60 m galvanized chain | |
| XC9300 | 2 vents for coach roof hatches | |
| XH1001 | Battery set, capacity: 1x 90 Ah + 2x 160 Ah AGM | |
| XH1110 | Deep charge protection for service batteries | |
| XV9010 | Blind set with flyscreens for hatches | |
| XV9060 | Blinds for hull windows | |
| XV9080 | Blinds for side coach roof windows | |
| XV9420 | Wind indicator | |
| XV9450 | Flagpole | |
| XV9901 | 6 fenders | |
| XV9902 | 4 mooring lines | |
| XV9950 | Dehler maintenance kit | |

| | | |
|---------------|---|-----------------|
| XW3101 | Upgrade - Flexiteek (colour selection) | 1.090 € |
| XC1311 | Flexiteek on coach roof | |
| XC1326 | Flexiteek on cockpit bottom | |
| XC1341 | Flexiteek on cockpit benches | |
| XC1351 | Flexiteek on bathing platform | |
| XW3102 | Upgrade - stainless steel anchor with chain | 4.590 € |
| XC9101 | Delta-anchor 20 kg, stainless steel, with 'Ultra' swivel and 100 m stainless steel chain | |
| XW3103 | Upgrade - Battery set Lithium-Ion | 8.690 € |
| XH1005 | Battery set, capacity: 1x 90 Ah + 6x 105 Ah Li-ion batteries | |
| XW3104 | Upgrade - automatic fold-out for bathing platform | 3.490 € |
| XC6005 | Automatic fold-out for bathing platform with remote control | |
| XW4000 | Competition Package | 6.990 € |
| XA3004 | Cove line - Competition | |
| XB9101 | Rudder - Competition | |
| XC5104 | 2 LEWMAR 50 Race Plus manual halyard winches | |
| XC5204 | 2 LEWMAR 55 Race Plus manual secondary winches | |
| XC5304 | 2 LEWMAR 55 Race Plus manual mainsheet winches | |
| XC9280 | Jib barber hauler with low-friction ring | |
| XW4001 | Upgrade - electric halyard winch | 3.690 € |
| XC5103 | 2 LEWMAR 50 Race halyard winches, port: manual - stb: electric with automatic fuse (only with XH1001 or XH1005) | |
| XW4002 | Upgrade - Competition Keel | 12.890 € |
| XB1002 | T-keel, cast iron/lead, (competition) draft: 2.58 m | |
| XW4003 | Upgrade - Side deck - colour | 1.790 € |
| XC1111 | Side decks, gelcoat colour: White Grey (RAL 7047) | |
| XW4004 | Upgrade - Cockpit bottom - colour | 1.190 € |
| XC1116 | Cockpit bottom, gelcoat colour: White Grey (RAL 7047) | |
| XW6000 | Gennaker Package | 7.390 € |
| XE3105 | QUANTUM Gennaker (colour selection - only with XE1000) | |
| XE3110 | Squeezer for Gennaker | |
| XE9003 | Gennaker/Freeride package incl. 2:1 halyard, 2 sheets, 2 blocks and padeyes | |
| XW6001 | Upgrade - Competition Gennaker | 1.590 € |
| XE3107 | QUANTUM Gennaker (Competition) (colour selection - only with XE1002) | |

| | | |
|---------------|-----------------------------------|----------------|
| XW6500 | Smart Connection Package | 2.990 € |
| XF4655 | Interior camera | |
| XK5031 | WLAN router incl. booster antenna | |

| | | |
|---------------|---|----------------|
| XW7000 | Entertainment Package | 1.990 € |
| XK1000 | FUSION MS-RA70N Multimedia radio with bluetooth - for saloon and cockpit (only with XK5000) | |
| XK2000 | 2x 2 high-end speakers in saloon and cockpit | |
| XK3000 | FUSION MS-NRX remote control in cockpit | |

| | | |
|---------------|--|--------------|
| XW7001 | Upgrade - premium radio | 790 € |
| XK1001 | FUSION APOLLO MS-RA770 Multimedia radio with Wi-Fi and touchscreen - for saloon and cockpit (only with XK5000) | |
| XK3001 | FUSION MS-ERX400 remote control in cockpit | |

| | | |
|---------------|--|----------------|
| XW7010 | Entertainment Package - Master cabin | 3.290 € |
| XK1010 | FUSION APOLLO MS-RA770 Multimedia radio with Wi-Fi and touchscreen - for master cabin (only with XK5000) | |
| XK2010 | 2 high-end speakers in master cabin | |
| XK4010 | TV preparation in master cabin | |
| XK4110 | LED TV flat screen in master cabin | |

| | | |
|---------------|------------------------------|----------------|
| XW7030 | TV Package | 4.490 € |
| XK4040 | TV preparation in saloon | |
| XK4140 | LED TV flat screen in saloon | |
| XK4240 | TV lifting system in saloon | |
| XK5020 | DVB-T2 antenna for TV | |

OPTIONS

excl. VAT

HULL

| | | |
|--------|--|----------|
| XA1001 | GRP hull, gelcoat colour: Grey (RAL 7040) | 5.290 € |
| XA1002 | GRP hull, painted, non metallic (colour selection) | 23.090 € |
| XA1003 | GRP hull, painted, metallic (colour selection) | 30.390 € |
| XA3001 | Waterline and cove line, coloured gelcoat (colour selection - not with XA1002 or XA1003) | 890 € |
| XA3002 | Waterline and cove line, painted, non metallic (colour selection - only with XA1002 or XA1003) | 990 € |
| XA3003 | Waterline and cove line, painted, metallic (colour selection - only with XA1002 or XA1003) | 1.190 € |

KEEL

| | | |
|--------|---|----------|
| XB1001 | L-keel, cast iron, draft: 1.85 m | 5.290 € |
| XB1002 | T-keel, cast iron/lead, (competition) draft: 2.58 m | 15.390 € |
| XB1003 | L-keel, cast iron/lead, draft: 2.48 m | 14.590 € |
| XB9000 | Keel and rudder - not mounted | 1.090 € |
| XB9101 | Rudder - Competition | 1.790 € |

LAYOUT & INTERIOR

| | | |
|--------|--|---------|
| XL2002 | B2: Saloon with L-galley, dining area on stb, sofa with chart table at the main bulkhead and head with separate shower stall on port | 1.190 € |
|--------|--|---------|

| | | |
|--------|--|---------|
| XL2003 | B3: Saloon with L-galley, dining area on stb, sofa with chart table and head with separate shower stall on port | 2.290 € |
| XL2004 | B4: Saloon with L-galley, dining area on stb, storage and sofa with chart table at the main bulkhead and head with separate shower stall on port | 2.990 € |
| XL3002 | C2: 2 aft cabins with double berth, locker and storage | 2.190 € |
| XL3003 | C3: 2 aft cabins: scissor berth, locker and storage on port and double berth, locker and storage on stb | 2.990 € |
| XL7002 | Saloon table with cushion, lowerable and convertible into double berth | 2.890 € |
| XL7221 | Bench in saloon on port, electric driven (not with XL2003 and XL7002) | 3.490 € |
| XL7601 | Worktop in galley - Black | 890 € |
| XL7602 | Worktop in galley - Dark Grey | 890 € |

WOOD (FURNITURE, FLOORBOARD)

| | | |
|--------|---|---------|
| XM1101 | Furniture - Teak | 7.390 € |
| XM1103 | Furniture - Oak | 7.390 € |
| XM1201 | Floorboard - Noce Nero | 1.090 € |
| XM1202 | Floorboard - Classic Stripes | 2.090 € |
| XM1203 | Floorboard - Piave Oak | 1.090 € |
| XM9000 | Floorboard - Wood style flooring in all showers | 790 € |

UPHOLSTERY

| | | |
|--------|---|---------|
| XN1100 | Deluxe mattresses for all berths | 3.390 € |
| XN2001 | Upholstery - Arctic (colour selection) | 1.290 € |
| XN2002 | Upholstery - Pacific (colour selection) | 2.090 € |
| XN2003 | Upholstery - Biscay (colour selection) | 2.890 € |
| XN2004 | Upholstery - Adriatic Leather (colour selection) | 5.290 € |
| XN2400 | Sun bed cushions on coach roof (colour selection) | 2.090 € |
| XN2500 | Cockpit cushions (colour selection) | 2.690 € |

DECK & OUTSIDE EQUIPMENT

| | | |
|--------|---|----------|
| XC1300 | Teak on side decks | 15.990 € |
| XC1301 | Flexiteek on side decks (colour selection) | 16.590 € |
| XC2201 | 2 GRP steering wheels, Y-spoke (black or white) | 1.790 € |
| XC3001 | Fixed cockpit table, stainless steel with folding teak tops and retractable LED light | 2.490 € |
| XC3004 | Removable cockpit table, stainless steel with foldable teak tops | 2.490 € |
| XC3030 | Instrument pod on coach roof (not with XE2012) | 990 € |
| XC4001 | Gateway stanchion | 990 € |
| XC4002 | Railing, stainless steel wire, competition performance | 1.190 € |
| XC5103 | 2 LEWMAR 50 Race halyard winches, port: manual - stb: electric with automatic fuse (only with XH1001 or XH1005) | 4.190 € |
| XC5201 | 2 LEWMAR 55 Race manual secondary winches | 2.690 € |
| XC5301 | 2 LEWMAR 55 Race manual mainsheet winches | 2.690 € |
| XC5302 | 2 LEWMAR 50 Race electrical mainsheet winches with automatic fuse (only with XH1001 or XH1005) | 7.890 € |
| XC6501 | Gangway, carbon, foldable with bag, 220 cm | 2.990 € |
| XC6602 | Bow ladder for easy access on the bow | 1.090 € |
| XC9021 | Rub rail, stainless steel | 2.090 € |

| | | |
|--------|---|----------|
| XC9051 | Electrical deck wash pump, mounted in bow area with outlet on deck | 1.190 € |
| XC9070 | Halyard bags | 590 € |
| XC9210 | Self tacking jib system (not with XE1002) | 2.590 € |
| XC9261 | GRP arch for cockpit - white, for mainsheet, instead of the traveller | 13.790 € |
| XC9280 | Jib barber hauler with low-friction ring | 790 € |

RIG & SAILS

| | | |
|--------|--|----------|
| XE1002 | Mast (Competition), carbon with rod rigging and black alu boom for pin top mainsail with flat deck furler | 52.990 € |
| XE2001 | Maindrop system with lazy jacks (colour selection) | 1.490 € |
| XE2012 | Sprayhood with stainless steel stake, 3 windows (1 openable) (colour selection) | 3.840 € |
| XE3010 | QUANTUM TP6 high-performance sails - full battened, UV-protected membrane, main and jib | 12.890 € |
| XE3021 | QUANTUM AC5 performance sail - full battened, triradial, self tacking jib (only with XC9210) | 5.990 € |
| XE3022 | QUANTUM TP6 high performance sail - full battened, UV-protected membrane, self tacking jib (only with XC9210) | 10.790 € |
| XE3300 | QUANTUM Freeride sail - with CX endless furler and storage bag (only with XE1000) | 7.190 € |
| XE3302 | QUANTUM Freeride sail (Competition) - with CX endless furler and storage bag (only with XE1002) | 8.090 € |
| XE3310 | QUANTUM AC5 performance sail - triradial, staysail with 2:1 halyard, CX endless furler and sheets | 7.190 € |
| XE3311 | QUANTUM TP6 high performance sail - UV-protected membrane, staysail with 2:1 halyard, CX endless furler and sheets | 11.790 € |
| XE4003 | Spinnaker package incl. carbon pole, halyard, 2 sheets, 2 blocks and padeyes | 5.990 € |
| XE9003 | Gennaker/Freeride package incl. 2:1 halyard, 2 sheets, 2 blocks and padeyes | 2.190 € |

NAVIGATION & INSTRUMENTS

| | | |
|--------|--|----------|
| XF2223 | 2 B&G Triton ² multifunction displays at companionway (only with XC3030) | 1.390 € |
| XF2224 | 2 B&G H5000 multifunction displays at companionway (only with XC3030 and XW2011) | 1.890 € |
| XF4000 | B&G Zeus ³ 7" chart plotter at chart table | 2.490 € |
| XF4560 | MyDehler Safety Cloud hardware with 30 days free trial subscription and an interior light, switchable by APP | 1.490 € |
| XF4600 | B&G AIS Class B transponder (only with Navigation Package) | 1.590 € |
| XF4650 | Thermal vision camera at mast (only with Navigation Package) | 6.390 € |
| XF4653 | SEA.AI Offshore ONE (only with Navigation Package) | 11.590 € |
| XF9001 | NMEA Engine information interface (only with chart plotter) | 1.290 € |

PROPULSION

| | | |
|--------|---|----------|
| XG1103 | Engine (Diesel, approx. 80 hp) - saildrive, 3 blade folding propeller | 5.290 € |
| XG3101 | Bowthruster, 12 V, retractable, incl. battery | 11.440 € |

EQUIPMENT

| | | |
|--------|---|----------|
| XH1601 | Country Version: US / JPN | 3.490 € |
| XH2101 | Generator, 4.0 kW / 4.5 kVA, incl. maintenance kit | 15.690 € |
| XH2201 | Inverter/charger, 12 V / 1600 W - 60 A, incl. larger AC panel (only with XH1001 or XH1005) | 2.790 € |
| XH3001 | Electric toilet with sea water flush - cabin layout B | 1.690 € |
| XH3011 | Electric toilet with sea water flush - cabin layout A | 1.690 € |
| XH4011 | Heating, hot air with up to 6 blowers (not with XH4511) | 7.740 € |
| XH4511 | Air conditioning, 28.000 BTU, 3 units: fwd cabin, saloon and aft cabin (incl. 2nd shore power plug) (not with XH4011) | 17.790 € |

PRICELIST



| | | |
|--------|--|---------|
| XH5100 | Add. fridge in galley (not with XH5210) | 2.190 € |
| XH5112 | Wine cooler in saloon (only with XL2004) | 2.590 € |
| XH5150 | Microwave in galley | 1.790 € |
| XH5210 | Dish washer in galley (not with XH5100) | 2.390 € |
| XH6001 | Grey water system for bathrooms and galley, tank: 70 l | 3.390 € |

RADIO & ENTERTAINMENT

| | | |
|--------|--|-------|
| XK5000 | VHF preparation with antenna and splitter for FM and AIS | 490 € |
|--------|--|-------|

ACCESSORIES

| | | |
|--------|---|---------|
| XV9120 | Cockpit table cover (colour selection) | 590 € |
| XV9130 | Cover for steering wheels (colour selection) | 690 € |
| XV9380 | Shrink wrap foil (for storage purpose only / not for transport) (not with XA1002 or XA1003) | 890 € |
| XV9960 | Electronic safe in forward cabin | 1.290 € |

SHIPPING & TRANSPORT

| | | |
|--------|--------------------------------|---------|
| XZ2001 | Loading on truck | 590 € |
| XZ2003 | Oversea shipping pack (cradle) | 3.490 € |
| XZ2020 | Ready for pickup | 690 € |

All mentioned prices in €, basic prices ex yard and excl. VAT. All weights and measures are calculated numbers based on the construction data. Changes in construction and equipment reserved. Above mentioned prices are recommended for ex yard deliveries within 4 month after order confirmation. For later delivery time the company reserves right to apply latest price list. Company reserves additional 15 working days when painted hull or deck is ordered. All measurements/figures are approximate. Errors and omissions excepted. Specification and material can be changed without notice. Valid from 2023.01.01 for deliveries until 2023.12.31.