



specification
& price list
DS41

LOA	12.52 m	41' 1"
LH	11.99 m	39' 4"
LWL	11.42 m	37' 6"
Beam	4.20 m	13' 9"
Draft	2.14 m	7' 0"
	1.85 m	6' 1"
Displacement approx.	11.20 t	24,692 lbs
Ballast approx.	3.13 t	6,900 lbs
Engine approx.	Diesel 41.9 kW	57 hp
Fresh water	475 l	125 gal
Fuel tank	200 l	53 gal
CE Certificate	A - 10	
Mast lenght above DWL		
standard	19.92 m	65' 4"
furling	20.17 m	66' 2"
Main approx.	48.20 m ²	519 sq ft
Jib approx.	37.60 m ²	405 sq ft
Reaching Yankee	56.80 m ²	611 sq ft
Gennaker A3	117.70 m ²	1,267 sq ft
Total sail area approx.	85.80 m ²	924 sq ft
Rlg	I 16.8 m	55' 1"
	J 4.7 m	15' 5"
	P 16.2 m	53' 2"
	E 5.5 m	18' 1"
Design	Dixon Yacht Design	
Interior	Hanse Design Team	



deck & interior layouts DS41

Standard

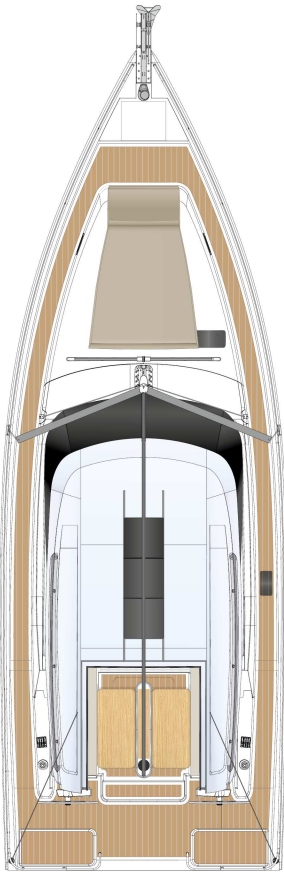

Standard



Standard

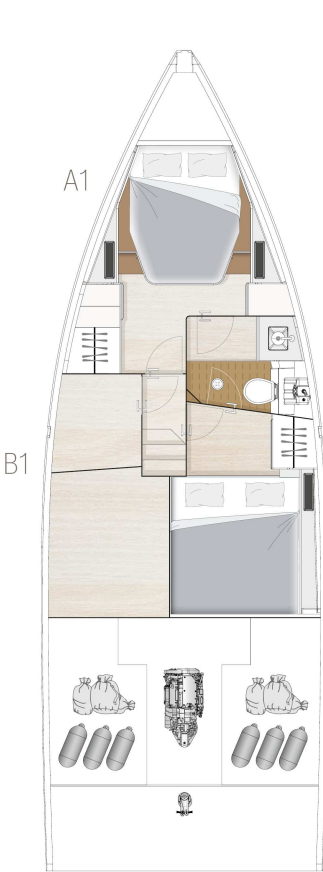

Option

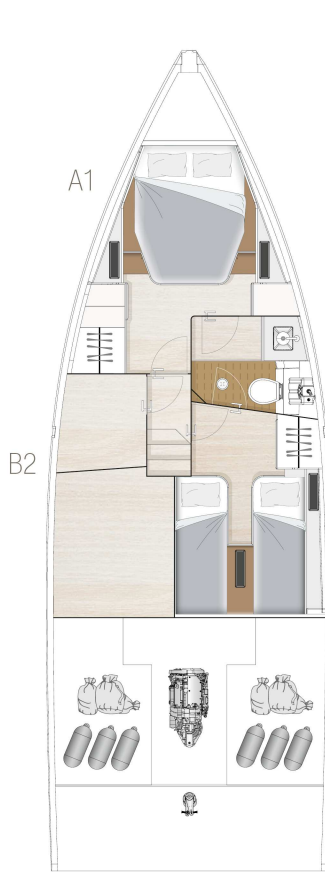

Option

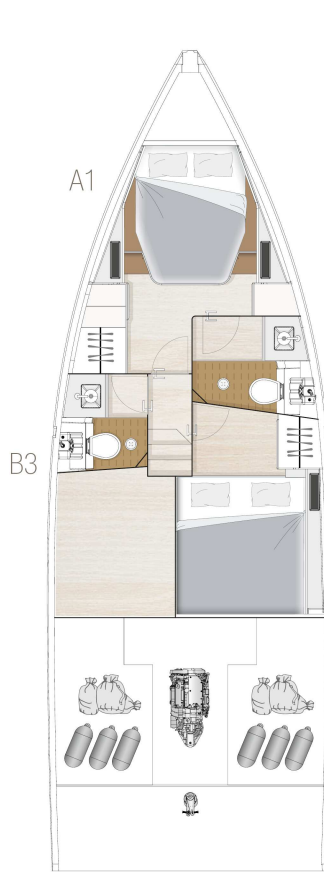

Option

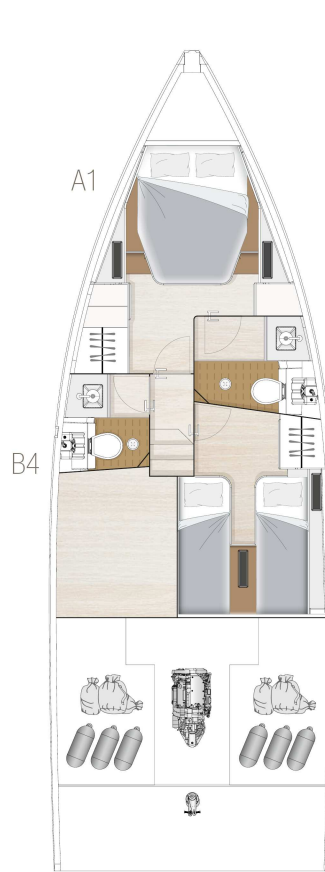

standard specification DS41

HULL

- 4 hull windows (3 on starboard, 1 on port)
- GRP hull, isophthalic gelcoat: Off White (RAL 9003), 1st layer vinyl ester resin and balsa sandwich laminat.
- Waterline and cove line, isophthalic gelcoat colour: Moody Grey (RAL 7034)

KEEL

- L-keel, cast iron, draft: 2.14 m
- GRP rudder with sea-water resistant aluminium shaft and selfaligning bearings

LAYOUT & INTERIOR

- A1: Master cabin with island double berth, storage space and head with separate shower stall
- B1: Guest cabin with double berth and storage locker
- C1: Saloon with full functional L-galley and dining area on stb - chart table on port and utility area under saloon floorboard
- 3-burner gas stove with oven, waste bin, 12 V fridge approx. 130 l, sink with mixing tab
- Interior furniture in high quality marine plywood, satin varnished
- Sliding door in deckhouse
- Galley, coloured, colour: white
- Worktop in galley - Marine Mineral Stone, colour: Grained Black

WOOD (FURNITURE, FLOORBOARD)

- Furniture - Traditional Mahogany - satin varnish
- Floorboard - New Zealand Acacia

UPHOLSTERY

- Comfort mattresses for all berths
- Upholstery - dorset, colour: Cream

DECK & OUTSIDE EQUIPMENT

- GRP deck with antislip surface, gelcoat colour: Off White (RAL 9003), 1st layer vinyl ester resin with blasa sandwich core.
- Teak on side deck, cockpit bottom, helmsman seats, cockpit benches and bathing platform
- Twin wheel steering system
- 2 stainless steel steering wheels with leather cover
- Cockpit table, stainless steel with folding teak tops
- Pulpit and pushpit, stainless steel
- Railing, stainless steel tube and wire, incl. integrated boarding ladder on both sides
- Halyards and control lines in cockpit at helm position, stern locker, 2 cockpit lockers, 6 retractable mooring cleats, handrail on coach roof, double anchor arm and anchor locker
- 2 LEWMAR 45 EST EVO electrical halyard winches
- Bathing platform, manual fold-out with swimming ladder

- 2 helmsman seats, foldable
- Anchor windlass, electrical, 1500 W, with automatic fuse, remote control with chain counter
- Delta-anchor 25 kg, galvanized with 60 m galvanized chain
- Self tacking jib system
- German mainsheet system
- Foldable window next to patio door at pantry
- Panoramic deckssaloon windows, central glass skylight for deckssaloon with 2 openable hatches, 1 fwd. coach roof front window, 1 coach roof hatch (for head - white opaque glass), 4 mitre-cut portlights at coach roof sides, glass skylight on forward coach roof with a big openable hatch (sz. 70)

RIG & SAILS

- Rig, anodized aluminium, deck stepped, with kicker, standing and running rigging and 2 reefs
- Bimini with sliding mechanism (colour selection)
- QUANTUM Blue Water Dacron sails - full battened, main and jib

NAVIGATION & INSTRUMENTS

- Illuminated compass
- Navigation lights - LED

PROPULSION

- Engine (Diesel, approx. 57 hp) - saildrive, 3-blade folding propeller
- Bowthruster, 12 V, incl. Battery - tunnel

EQUIPMENT

- 12 V and 230 V electric system, 230 V shore power and sockets in cabins and heads
- Battery set, capacity: 1x 90 Ah + 2x 160 Ah AGM
- Country Version: EU / AUS
- Battery charger 50 A
- Shore power 230 V or 110 V
- Electric toilet with sea water flush (master cabin)
- Shower unit in cockpit, warm-/coldwater
- LPG gas system, stowage for 1 gas bottle
- Blackwater system (appr. 54 l per head) with deck extraction and seacock for head
- Freshwater system with electric pump and 20 l hotwater, heated also by main engine
- Fresh water tank, appr. 295 l
- Add. fresh water tank, appr. 180 l
- Fuel tank, approx. 200 l

ACCESSORIES

- Blind set with flyscreens for deck hatches
- Skysol blinds for deckshouse windows
- Venetian blinds for hull windows

standard specification DS41

- Wind indicator
- Flagpole
- Add. winch handle
- Mast steps

SHIPPING & TRANSPORT

- CE - Certificate cat. A - 10 / B - 12
- Owners manual
- EC - Type Examination Certificate

standard price list packages DS41

AS PER STANDARD SPECIFICATION **excl. VAT**
524.900 €

XW2000 Raymarine Navigation Package 15.590 €

XF2210	2 Raymarine i70s multifunction displays at helm position, incl. transducer (speed/wind/depth/temperature)
XF3000	Raymarine VHF RAY90 at chart table, incl. handset
XF4010	2 Raymarine Axiom 9" GPS chart plotter, one per helm position
XF4600	AIS Class B transponder
XF5000	Raymarine Evolution Autopilot with p70Rs display and S100 remote control at helm position, port
XF9001	NMEA Engine information interface for chart plotter
XK5000	VHF preparation with antenna and splitter for FM and AIS

XW2001 Upgrade - Axiom Pro 2.290 €

XF4011	2 Raymarine Axiom Pro 9" GPS chart plotter, one per helm position
--------	---

XW2005 Upgrade - 3rd Helmsmanstation at chart table 3.490 €

XF5110	Raymarine p70Rs Autopilot display at chart table
XG2101	Add. electronic throttle control at chart table

XW6500 Smart Connection Package 2.990 €

XF4655	Interior camera
XK5031	WLAN router incl. booster antenna

XW7000 Entertainment Package - Saloon 3.590 €

XK1000	FUSION APOLLO MS-RA770 Multimedia radio with Wi-Fi and touchscreen - for saloon and cockpit (only with XK5000)
--------	--

XK2000	2 high-end 2-way speakers in saloon and cockpit
XK3070	FUSION MS-ERX400 remote control in cockpit

XW7010 Entertainment Package - Master cabin 2.290 €

XK1010	FUSION APOLLO MS-RA770 Multimedia radio with Wi-Fi and touchscreen - for master cabin (only with XK5000)
XK2010	2 high-end 2-way speakers in master cabin

XW7030 TV Package - Saloon 1.690 €

XK4040	TV preparation in saloon
XK4140	LED TV flat screen in saloon
XK4240	Manual TV folding system in saloon

standard price list options DS41

		excl. VAT
HULL		
XA1001	GRP hull, coloured gelcoat (colour selection)	4.390 €
XA1002	GRP hull, painted, non metallic (colour selection)	20.990 €
XA1003	GRP hull, painted, metallic (colour selection)	27.290 €
XA3001	Waterline and cove line, coloured gelcoat (colour selection - only with XA1000 or XA1001)	790 €
XA3002	Waterline and cove line, painted, non metallic (colour selection - only with XA1002 or XA1003)	890 €
XA3003	Waterline and cove line, painted, metallic (colour selection - only with XA1002 or XA1003)	1.840 €
KEEL		
XB1001	L-keel, cast iron, draft: 1.85 m	8.990 €
XB9000	Keel and rudder - not mounted	990 €
LAYOUT & INTERIOR		
XL2002	B2: Guest cabin with two single berth and storage locker	690 €
XL2003	B3: Guest cabin with double berth and guest head with shower	4.390 €
XL2004	B4: Guest cabin with two single berth and guest head with shower	5.090 €
XL6202	Galley, coloured, colour: dark grey	1.190 €
XL7001	Saloon table electrically lowerable with cushions, convertible into double berth	2.890 €
XL7601	Worktop in galley - Marine Mineral Stone (colour selection)	790 €
WOOD (FURNITURE, FLOORBOARD)		
XM1102	Furniture - Teak	8.390 €
XM1104	Furniture - Golden Oak	8.390 €
XM1150	Furniture - High Gloss Finish (only with XM1100)	10.190 €

XM1201	Floorboard - Continental Oak	1.190 €
UPHOLSTERY		
XN2001	Upholstery - oxford (colour selection)	1.090 €
XN2002	Upholstery - devon (colour selection)	1.690 €
XN2003	Upholstery - orkney (colour selection)	1.990 €
XN2004	Upholstery - yorkshire leather (colour selection)	4.990 €
XN2200	Sun bed cushions on foredeck (colour selection)	2.290 €
XN2501	Cockpit cushions with backrest (colour selection)	3.090 €
XN4001	Curtains for saloon sliding door (colour selection)	1.090 €
DECK & OUTSIDE EQUIPMENT		
XC1361	Flexiteek on side deck, cockpit bottom, helmsman seats, cockpit benches and bathing platform (colour selection)	2.990 €
XC2201	2 GRP steering wheels, Y-spoke (black or white)	1.790 €
XC5200	2 LEWMAR 45 ST EVO manual secondary winches, on stainless steel pedestal	2.990 €
XC6001	Bathing platform, manual fold-out with swimming stairs	2.490 €
XC6005	Automatic fold-out for bathing platform with remote control	2.490 €
XC7200	Davits for dinghi	2.890 €
XC9020	Rub rail, teak	2.690 €
XC9021	Additional stainless steel rail (only with XC9020)	1.990 €
XC9050	Electrical deck wash pump inside anchor locker	1.190 €
XC9101	Delta-anchor 25 kg, stainless steel, with 'Power Ball' swivel and 100 m stainless steel chain	4.290 €
XC9201	Genoa tracks (not with XE1220 or XE1221)	1.190 €
XC9423	Fixed window next to patio door at pantry	0 €
RIG & SAILS		
XE1001	Rig, anodized aluminium with manual inmast furling system	4.190 €

standard price list options DS41

XE1010	Rig, anodized aluminium with electric inmast furling system	10.290 €
XE1210	Electric jib furler	11.490 €
XE1220	Second forestay with furler, manual and genoa tracks with pin stop (only with XC5200)	6.790 €
XE1221	Second forestay with furler, electrical and genoa tracks with pin stop	12.690 €
XE2001	Lazy-bag with lazy jacks (colour selection - not with XE1001 or XE1010)	1.290 €
XE3005	QUANTUM AC5 performance sails - full battened, triradial, main and jib	7.490 €
XE3010	QUANTUM TP6 high-performance sails - full battened, UV-protected membrane, main and jib	13.790 €
XE3024	QUANTUM AC5 Genoa 135% (only with XE1220 or XE1221)	7.990 €
XE3025	QUANTUM TP6 Genoa 135%, with UV protection (only with XE1220 or XE1221)	13.690 €
XE3105	QUANTUM Gennaker incl. squeezer (colour selection)	4.190 €
XE9004	Gennaker package incl. halyard, 2 sheets, 2 blocks and padeyes	1.690 €
XE9100	Spreader lights, LED, 4 up and 4 down	3.390 €

NAVIGATION & INSTRUMENTS

XF4000	Raymarine Axiom Pro 12" GPS chart plotter at chart table	5.390 €
XF4500	Raymarine Quantum 2 Radar, on first spreader	4.090 €
XF4560	MyMoody Safety Cloud hardware with 30 days free trial subscription and an interior light, switchable by APP	1.490 €
XF4650	Thermal vision camera at mast (only with Navigation Package)	6.390 €
XF4653	SEA.AI Offshore ONE (only with Navigation Package)	11.590 €

PROPULSION

YG1103	Engine (Diesel, approx. 80 hp) - saildrive, 3-blade folding propeller	6.790 €
YG1810	Add. electronic throttle control and thruster control at helm position, on port	3.390 €

EQUIPMENT

XH1001	Battery set, capacity upgraded to: 1x 90 Ah + 4x 160 Ah AGM	1.090 €
XH1110	Deep charge protection for service batteries	1.390 €
XH1601	Country Version: US / JPN	3.490 €
XH2101	Generator 8000i, 6,4 kW / 0 - 7,2 kVA, incl. maintenance kit (MPL housing)	19.490 €
XH2201	Inverter/charger, 12 V / 2600 W - 100 A, incl. AC panel (only with XH1001)	3.990 €
XH3011	Electric toilet with sea water flush (guest cabin)	1.890 €
XH3200	Freshwater dockside connection in transom	590 €
XH4011	Heating, hot air with blowers in cabins and heads	7.890 €
XH4510	Air conditioning, 24.000 BTU, 2 units: saloon and master cabin, incl. 2nd shore power	19.190 €
XH4511	Air conditioning, 8.000 BTU, 1 unit: guest cabin (only with XH4510)	6.990 €
XH5100	Add. fridge in storage under saloon floorboard	1.940 €
XH5150	Microwave in saloon	1.590 €
XH5210	Dishwasher in saloon	2.390 €
XH5311	Washing machine with dryer function, front opening in saloon stowage	3.490 €
XH5409	Gas leak detector	990 €
XH5610	Grey-water system "Lakes" for bathrooms and galley, tank: 100 l - no hull-through fittings for grey and black water, fresh-water capacity reduced	1.690 €
XH6001	Grey-water system for bathrooms and galley, tank: 100 l - fresh-water capacity reduced	1.890 €
XH6020	Add. fuel tank, appr. 200 l (only with XH2101)	3.490 €

RADIO & ENTERTAINMENT

XK5000	VHF preparation with antenna and splitter for FM and AIS	590 €
--------	--	-------

ACCESSORIES

XV9045	External sunshade for deckshouse windows (colour selection)	2.690 €
XV9120	Cover for cockpit table (colour selection)	690 €

standard price list options

DS41

XV9130	Cover for steering wheels (colour selection)	690 €
XV9380	Shrink wrap foil (for storage purpose only / not for transport) (not with XA1002, XA1003, XA3002, XA3003)	790 €
XV9901	6 fenders	490 €
XV9902	4 mooring lines, plaited	390 €

SHIPPING & TRANSPORT		
XZ2001	Loading on truck	690 €
XZ2003	Oversea shipping pack (cradle)	3.390 €
XZ2020	Ready for Pickup	690 €

All mentioned prices in €, basic prices ex yard and excl. VAT. All weights and measures are calculated numbers based on the construction data. Changes in construction and equipment reserved. Above mentioned prices are recommended for ex yard deliveries within 4 month after order confirmation. For later delivery time the company reserves right to apply latest price list. Company reserves additional 15 working days when painted hull or deck is ordered. All measurements/figures are approximate. Errors and omissions excepted. Specification and material can be changed without notice. Valid from 2023.01.01 for deliveries until 2024.12.31.