

# PRICELIST & SPECIFICATION

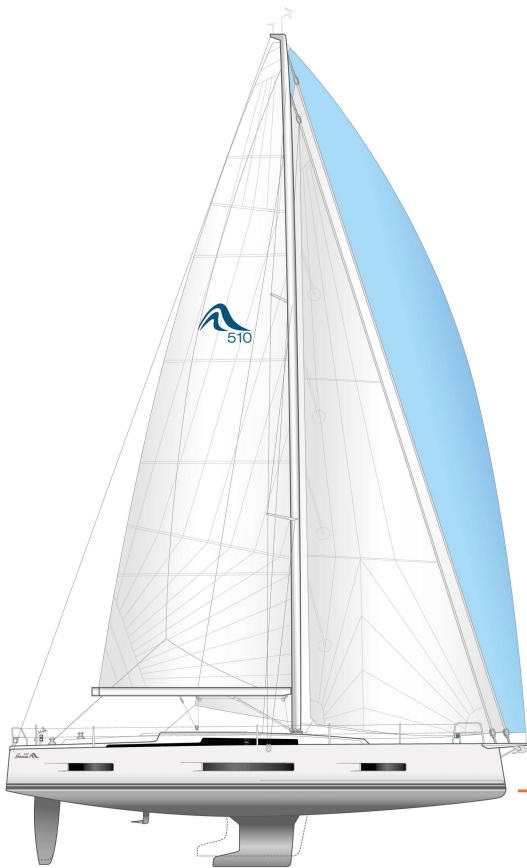

LOA		15.97 m	52' 5"
Hull length		15.25 m	50' 0"
LWL		14.50 m	47' 7"
Beam		4.91 m	16' 1"
Draft			
shallow keel		1.98 m	6' 6"
L-keel, medium		2.43 m	8' 0"
Displacement			
shallow keel	approx.	16.94 t	37,346 lbs
L-keel, medium	approx.	16.54 t	36,464 lbs
Ballast			
shallow keel	approx.	4.76 t	10,494 lbs
L-keel, medium	approx.	4.36 t	9,612 lbs
Engine Diesel			
standard	approx.	80 PS	80 hp
option	approx.	110 PS	110 hp
Fuel tank	approx.	200 l	53 gal
Fresh water	approx.	450 l	119 gal
CE Certificate		A - 12	
Design		Berret - Racoupeau	
Interior		Berret - Racoupeau	

Mast length above WL	approx.	23.55 m	77' 3"
Upwind sail area	approx.	125.50 m <sup>2</sup>	1,350 sq ft
Downwind sail area	approx.	272.00 m <sup>2</sup>	2,927 sq ft
Main sail			
standard	approx.	66.00 m <sup>2</sup>	710 sq ft
furling	approx.	66.00 m <sup>2</sup>	710 sq ft
Jib	approx.	53.00 m <sup>2</sup>	570 sq ft
Genoa	approx.	59.50 m <sup>2</sup>	640 sq ft
Reacher	approx.	94.00 m <sup>2</sup>	1,011 sq ft
Gennaker	approx.	206.00 m <sup>2</sup>	2,217 sq ft

All measurements/figures are approximate. Errors and omissions excepted. All weights are specified in MLC. Specification and material can be changed without notice. Valid from 2023.07.01 for deliveries until 2024.12.31.

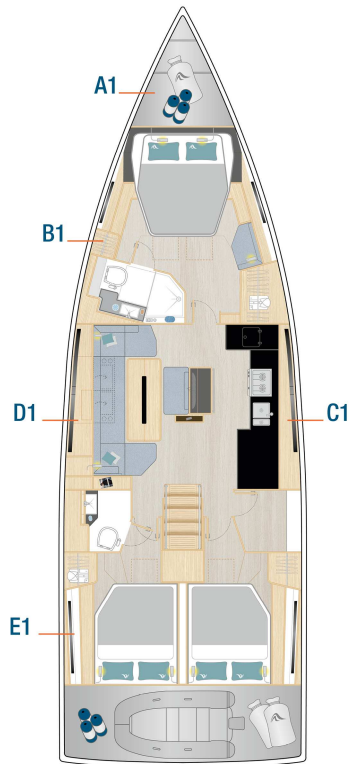
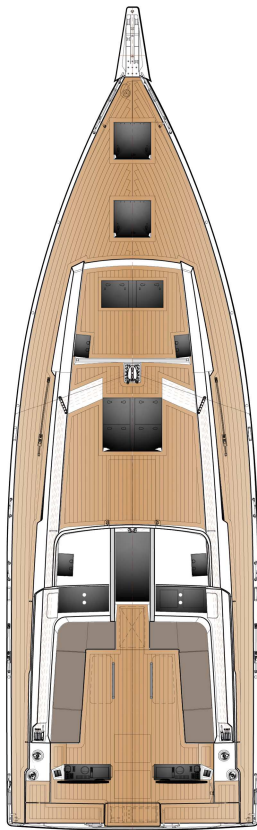

Standard

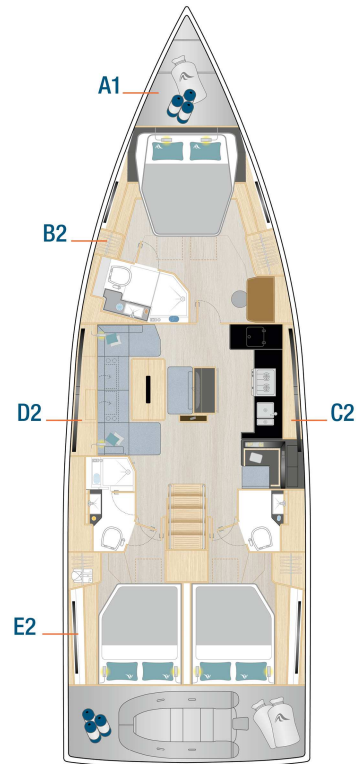

Option

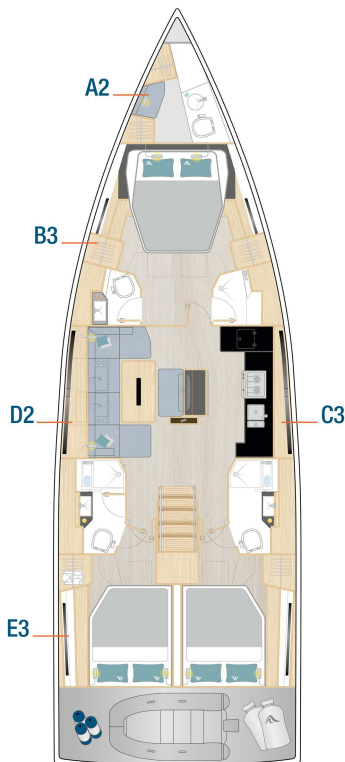

Option

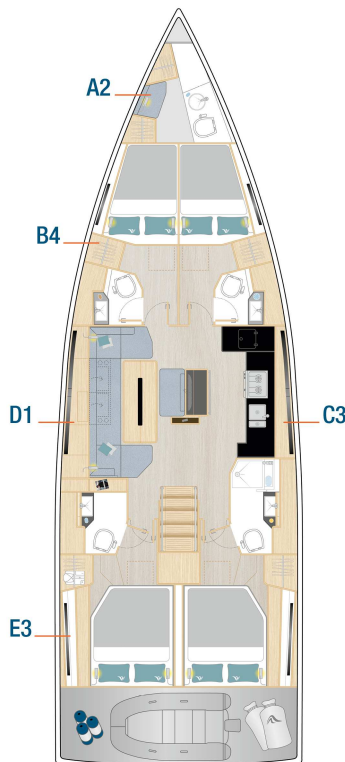

Option

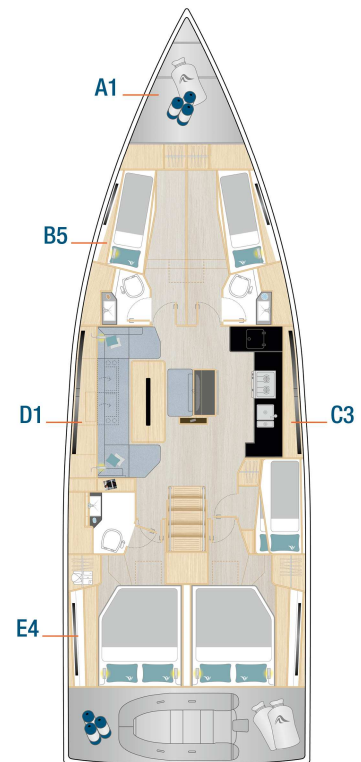

Option

## HULL

- 8 hull windows (4 each side)
- GRP hull, isophthalic gelcoat, colour: Signal White (similar RAL 9003), 1st layer vinyl ester resin and balsa sandwich laminat
- Waterline, isophthalic gelcoat, colour: Dark Grey (similar RAL 7043)

## KEEL

- L-keel, cast iron, draft: 2.43 m
- GRP rudder with sea-water resistant aluminium shaft and selfaligning bearings

## LAYOUT & INTERIOR

- A1: Saillocker
- B1: Master cabin with island double berth, 2 lockers, seating area and ensuite head with separate shower stall (only with A1 layout)
- C1: Saloon with full functional large L-galley on stb (only with E1 or E2 layout)
- D1: Spacious saloon with large dining area with bar, library and head on port
- E1: 2 aft cabins with double berth, storage space and storage room on stb (only with C1 or C2 layout)
- 3-burner gas stove with oven, waste bin, 12 V fridge approx. 135 l, double stainless steel sink with mixing tab
- Interior furniture in high quality marine plywood, Satin Varnish
- Hanse companionway closing system
- Saloon table, fixed
- Worktop in galley and heads - Black Quartz

## WOOD (FURNITURE, FLOORBOARD)

- Furniture - Mahogany Style, Satin Varnish
- Galley cupboard fronts in wood colour
- Floorboard - Acacia

## UPHOLSTERY

- Mattresses for all berths
- Upholstery - Monte Carlo, colour: Cream

## DECK & OUTSIDE EQUIPMENT

- GRP deck with antislip surface, isophthalic gelcoat, colour: Signal White (similar RAL 9003), 1st layer vinyl ester resin with balsa sandwich core. 2 cockpit lockers, 1 space for life raft, dinghy garage, stowage for running rigging at helm position and in the

steps from the cockpit to side deck, anchor locker at bow.

- Synthetic teak on cockpit bottom (colour selection)
- Synthetic teak on cockpit benches (colour selection)
- Synthetic teak on bathing platform (colour selection)
- Twin wheel steering system with emergency tiller
- 2 stainless steel steering wheels with leather cover
- Cockpit table, stainless steel with teak tops, on stb
- Cockpit table, stainless steel with teak tops, on ps
- Pulpit and pushpit, stainless steel
- Railing, incl. stanchions and stainless steel wire
- Covered halyards and control lines lead to cockpit helmposition, organizers and jammers, 4 mooring cleats, handrails on coach roof
- 2 LEWMAR 50 ST EVO manual halyard winches
- Bathing platform, manual fold-out with swimming ladder
- Composite bowsprit with integrated anchor and forestay fitting, gennaker eye
- Self tacking jib system
- Mainsheet system
- 8 large and 6 small deck hatches - openable, anchor locker hatch
- 4 large coach roof side windows - openable, 4 portlights in coach roof

## RIG & SAILS

- Rig, anodized aluminium, deck stepped, with kicker, standing and running rigging and 2 reefs
- Backstay tensioner, manual
- Manual jib furler
- ELVSTRØM Dacron sails - full battened, main and jib
- Dyneema halyards for main and jib

## NAVIGATION & INSTRUMENTS

- Illuminated compass at each helm
- Navigation lights - LED

## PROPULSION

- Fuel tank, approx. 200 l
- Engine (Diesel, approx. 80 hp) - saildrive, 3-blade fix propeller

## EQUIPMENT

- 12 V and 230 V electric system with main panels and 230 V shore power and sockets in cabins and heads
- Battery set, capacity: 1x 90 Ah + 2x 160 Ah AGM
- Country Version: EU / AUS
- Battery charger 50 A
- Manual toilet with sea water flush - cabin layout B1, B2 or B3
- Manual toilet with sea water flush - cabin layout D1 or D2
- LPG gas system, stowage for 1 gas bottle
- Black water system (appr. 85 l each bathroom) with deck extraction and seacock for head, electric and manual bilge pump
- Fresh water tank, appr. 450 l
- Fresh water system with electric pump and 40 l hot water, heated also by main engine

## SHIPPING & TRANSPORT

- CE - Certificate cat. A - 12, B - 14, C - 18
- Owners manual
- EC - Type Examination Certificate

## AS PER STANDARD SPECIFICATION

excl. VAT  
**449.900 €**

## PACKAGES

### XW2000 Raymarine Navigation Package **14.490 €**

XF2000	2 instrument pods (1 per helm station)
XF2200	2 Raymarine i70s multifunction displays, 1 per helm station, incl. transducer (wind/depth/speed/temperature)
XF3000	Raymarine VHF Ray63 at chart table, incl. wireless remote handset (only with XK5000)
XF4030	Raymarine AXIOM PRO 9 S chart plotter with HybridTouch multifunction display at helm station, stb
XF5000	Raymarine Evolution Autopilot with p70s display and wireless remote control
XH2090	Wireless charging at helm station (waterproof)
XK5000	VHF preparation with antenna and splitter for FM and AIS

### XW2001 Upgrade - second chart plotter **2.490 €**

XF4031	Raymarine AXIOM PRO 9 S chart plotter with HybridTouch multifunction display at helm station, ps
--------	--

### XW2002 Upgrade - 12" chart plotter **4.790 €**

XF4040	Raymarine AXIOM PRO 12 S chart plotter with HybridTouch multifunction display at helm station, stb
XF4041	Raymarine AXIOM PRO 12 S chart plotter with HybridTouch multifunction display at helm station, ps

### XW3000 Cruising Package **14.990 €**

XC1334	Synthetic teak on helmsman seats (colour selection - only with XC9060)
XC9060	2 helmsman seats, foldable (only with XC1333 or XC1334)
XC9062	Helmsman footrests (free mountable)
XC9080	2 additional cleats, midship (1 each side)
XC9090	Anchor windlass, electrical, 1000 W, automatic fuse, remote control
XC9100	Delta-anchor 25 kg, galvanized with 60 m galvanized chain
XC9402	Cockpit portlight, aft cabins
XH1001	Battery set, capacity: 1x 90 Ah + 4x 160 Ah AGM
XH3110	Shower unit in cockpit, warm-/coldwater
XH5030	Water akku for pressure equalization
XV9420	Wind indicator
XV9450	Flagpole
XV9901	6 fenders

XV9902	4 mooring lines
XV9910	Add. winch handle
XV9920	Mast steps
XV9950	Hanse maintenance kit

---

<b>XW3001</b>	<b>Upgrade - Real Teak</b>	<b>990 €</b>
---------------	----------------------------	--------------

XC1325	Real teak on cockpit bottom
XC1333	Real teak on helmsman seats (only with XC9060)
XC1340	Real teak on cockpit benches
XC1350	Real teak on bathing platform

---

<b>XW3002</b>	<b>Upgrade - stainless steel anchor with chain</b>	<b>4.490 €</b>
---------------	--	----------------

XC9101	Delta-anchor 25 kg, stainless steel, with 'Ultra swiffel' swivel and 100 m stainless steel chain
--------	--

---

<b>XW3003</b>	<b>Upgrade - Anchor windlass 1500 W</b>	<b>1.890 €</b>
---------------	---	----------------

XC9088	Combined mooring/anchor windlass, electrical, 1500 W, automatic fuse, remote control with chain counter (only with XH1001 or XH1005)
--------	--

---

<b>XW3004</b>	<b>Upgrade - Battery set Lithium</b>	<b>8.390 €</b>
---------------	--------------------------------------	----------------

XH1005	Battery set, capacity: 1x 90 Ah + 6x 105 Ah Lithium
--------	---

---

<b>XW3005</b>	<b>Upgrade - 4 enlarged retractable cleats</b>	<b>3.490 €</b>
---------------	--	----------------

XC9081	4 enlarged cleats - bow and stern, retractable and 4 standard size cleats, retractable - midship (2 each side)
--------	--

---

<b>XW4000</b>	<b>Performance Package</b>	<b>9.490 €</b>
---------------	----------------------------	----------------

XC2201	2 GRP steering wheels, Y-spoke (black or white)
XE3005	ELVSTRØM SPS performance sails - full battened, triradial main and jib
XE9002	Selden MDS mainsail slider system

---

<b>XW4100</b>	<b>Gennaker Package</b>	<b>7.390 €</b>
---------------	-------------------------	----------------

XE3100	ELVSTRØM Gennaker (colour selection - only with XC9171)
XE3110	Squeezer for Gennaker
XE9003	Gennaker package incl. halyard, 2 sheets, 2 blocks and padeyes (only with XC9171)

---



## **XW5000 Comfort Package 8.390 €**

XC9032	Courtesy lights in cockpit
XC9033	Courtesy lights at companionway
XC9040	Exterior Light Signature
XC9300	2 vents for coach roof hatches
XL9001	Courtesy lights in saloon
XL9003	Indirect lights in saloon and cabins
XL9004	LED overhead lights in saloon and cabins, dimmable
XL9010	SLS - Scenario light system - touch screen controller and dimmer in saloon and fwd cabin
XN2500	Cockpit cushions (colour selection)
XV9010	Blind set with flyscreens for deck hatches
XV9060	Blinds for hull windows
XV9080	Blinds for side coach roof windows

## **XW6000 Flagship Package 10.490 €**

XL7235	Headboards for aft cabins
XL7410	Leather covered handrails
XL7420	Soft material covered bulkheads in the saloon
XN2055	Luxury upholstery with multifunction backrests

## **XW6500 Smart Connection Package 3.390 €**

XF4655	Interior camera
XK5031	WLAN router incl. booster antenna

## **XW7000 FUSION Entertainment Package - Saloon 3.590 €**

XK1000	FUSION APOLLO MS-RA770 Multimedia radio with Wi-Fi and touchscreen - for saloon and cockpit (only with XK5000)
XK1200	Subwoofer with integrated amplifier in saloon
XK2040	4 high-end speakers in saloon
XK2070	2 high-end speakers in cockpit
XK3000	FUSION MS-ERX400 remote control in cockpit
XK5030	FUSION wireless link - remote control via mobile devices

<b>XW7001</b>	<b>FUSION Entertainment Package - Master cabin (only with B1 or B2 layout)</b>	<b>3.890 €</b>
XK1010	FUSION APOLLO MS-RA770 Multimedia radio with Wi-Fi and touchscreen - for master cabin (only with XK5000)	
XK2010	2 high-end speakers in master cabin	
XK4110	LED TV flat screen in master cabin	
<b>XW7010</b>	<b>JL Entertainment Package - Saloon</b>	<b>7.190 €</b>
XK1001	JL Media Master MM50 with Bluetooth - for saloon and cockpit (only with XK5000)	
XK2041	4 JL Audio speakers in saloon	
XK2071	2 JL Audio speakers in cockpit	
XK3001	JL Audio MMR-40 remote control in cockpit	
<b>XW7011</b>	<b>JL Entertainment Package - Master cabin (only with B1 or B2 layout)</b>	<b>4.490 €</b>
XK1011	JL Media Master MM50 with Bluetooth - for master cabin (only with XK5000)	
XK2011	2 JL Audio speakers in master cabin	
XK4110	LED TV flat screen in master cabin	
<b>XW7030</b>	<b>TV Package - Saloon</b>	<b>4.490 €</b>
XK4100	LED TV flat screen in saloon	
XK4240	TV lifting system in saloon	
XK5020	DVB-T2 antenna for TV	

## OPTIONS

excl. VAT

### HULL

XA1001	GRP hull, gelcoat colour: Grey (similar RAL 7040)	<b>6.090 €</b>
XA1002	GRP hull, painted, non metallic (colour selection)	<b>27.790 €</b>
XA1003	GRP hull, painted, metallic (colour selection)	<b>34.590 €</b>
XA3001	Waterline, coloured gelcoat (colour selection - only with XA1000 or XA1001)	<b>890 €</b>
XA3002	Waterline, painted, non metallic (colour selection - only with XA1002 or XA1003)	<b>990 €</b>
XA3003	Waterline, painted, metallic (colour selection - only with XA1002 or XA1003)	<b>1.190 €</b>

### KEEL

XB1001	L-keel, cast iron, draft: 1.98 m	<b>4.190 €</b>
XB9000	Keel and rudder - not mounted	<b>1.090 €</b>



## LAYOUT & INTERIOR

XL1002	A2: Crew cabin with sink, toilet and storage space (only with B3, B4 or B5 layout)	8.390 €
XL2002	B2: Master cabin with island double berth, vanity table and ensuite head with separate shower stall (only with A1 layout)	1.090 €
XL2003	B3: Master cabin with island double berth, 2 lockers, ensuite head and separate shower stall	2.790 €
XL2004	B4: 2 fwd cabins with double berth, storage space and separate heads	5.290 €
XL2005	B5: 2 fwd cabins with bunk berth, storage space and separate heads	5.490 €
XL3002	C2: Saloon with full functional L-galley and chart table on stb (only with E1 or E2 layout)	3.590 €
XL3003	C3: Saloon with full functional L-galley on stb (only with E3 or E4 layout)	990 €
XL4002	D2: Saloon with dining area with bar and head with separate shower stall on port	1.190 €
XL5002	E2: 2 aft cabins with double berth, storage space and ensuite head on stb (only with C1 or C2 layout)	1.890 €
XL5003	E3: 2 aft cabins with double berth, storage space and ensuite head on port and ensuite head with separate shower stall on stb (only with C3 layout)	3.490 €
XL5004	E4: 2 aft cabins with double berth, storage space and cabin on stb with double bunkbed (only with C3 layout)	1.690 €
XL6010	Furniture for utility room instead of storage room in layout E1	1.690 €
XL6050	Day head door for head in saloon on port side (only with E2 or E3 layout)	1.090 €
XL7001	Saloon table electrically lowerable with cushions, convertible into double berth, for D2 layout	2.790 €
XL7002	Large saloon table electrically lowerable with cushions, convertible into double berth, for D1 layout	4.990 €
XL7601	Worktop in galley and heads - Off White	890 €
XL7602	Worktop and sink of the galley in Marine Mineral Stone (colour selection)	2.990 €

## WOOD (FURNITURE, FLOORBOARD)

XM1102	Furniture - Teak	6.290 €
XM1103	Furniture - Canadian Chestnut	6.290 €
XM1104	Furniture - French Oak	6.290 €
XM1161	Galley cupboard fronts coloured (partial as per design - colour selection)	2.090 €
XM1201	Floorboard - Classic Stripes	2.190 €
XM1202	Floorboard - Noce Nero	1.190 €
XM1203	Floorboard - Delight Oak	1.190 €
XM9000	Floorboard - wooden grating in all heads and showers	1.690 €

## UPHOLSTERY

XN1100	Comfort mattresses for all berths (excluded A2, B5 and E4 layout)	3.490 €
XN2001	Upholstery - Sorrento (colour selection)	1.390 €

XN2002	Upholstery - Florence (colour selection)	2.090 €
XN2003	Upholstery - Monaco (colour selection)	3.190 €
XN2004	Upholstery - Portofino Leather (colour selection)	6.990 €
XN2400	Sun bed cushions on coach roof (colour selection)	2.190 €
XN2503	Cushion for helmsman seats (colour selection - only with XC9060)	790 €
XN2505	Cushion for wetbar (colour selection - only with XC3100)	490 €

## DECK & OUTSIDE EQUIPMENT

XC1300	Real teak on side deck	22.190 €
XC1301	Synthetic teak on side deck (colour selection)	21.590 €
XC1310	Real teak on coach roof	8.690 €
XC1311	Synthetic teak on coach roof (colour selection)	8.190 €
XC1333	Real teak on helmsman seats (only with XC9060)	1.290 €
XC1334	Synthetic teak on helmsman seats (colour selection - only with XC9060)	1.190 €
XC1340	Real teak on cockpit benches	590 €
XC1350	Real teak on bathing platform	1.290 €
XC2201	2 GRP steering wheels, Y-spoke (black or white)	1.890 €
XC3004	Cockpit table with teak top, electrically lowerable into sunbed incl. upholstery and cockpit bench extension, on stb	3.390 €
XC3005	Cockpit table with teak top, electrically lowerable into sunbed incl. upholstery and cockpit bench extension, on ps	3.390 €
XC3100	Wetbar with BBQ and sink with mixing tap (only with XC9060)	5.690 €
XC4001	Gateway stanchion	990 €
XC5102	2 LEWMAR 55 EST EVO electrical halyard winches with automatic fuse (only with XH1001 or XH1005)	10.490 €
XC5200	2 LEWMAR 55 ST EVO manual secondary winches	3.490 €
XC5202	2 LEWMAR 55 EST EVO electrical secondary winches with automatic fuse (only with XH1001 or XH1005)	12.890 €
XC6005	Automatic driven fold-out for standard bathing platform with remote control and comfort stairs to the bathing platform	8.990 €
XC6008	Swimming stairs, extractable, manual (only with XC6005)	3.390 €
XC6501	Gangway, carbon, foldable with bag, 220 cm	2.990 €
XC6601	Stainless steel ladder for gateway exit, foldable (only with XC4001)	1.090 €
XC7001	Hanse Smart Tender System (only with XC6005)	8.990 €
XC7100	Air compressor for tender	890 €
XC7200	Davits, telescopic	3.990 €
XC9020	Rub rail, teak	2.590 €
XC9021	Additional stainless steel rail (only with XC9020)	2.590 €
XC9036	LED lights for side decks, integrated in toerail, white	3.490 €

XC9041	4 underwater lights below transom	<b>4.590 €</b>
XC9051	Electrical deck wash pump, mounted in bow area with outlet on deck	<b>1.190 €</b>
XC9060	2 helmsman seats, foldable (only with XC1333 or XC1334)	<b>2.890 €</b>
XC9171	Composite bowsprit with integrated anchor and forestay fitting with double mooring roll incl. 2nd forestay and gennaker eye	<b>2.790 €</b>
XC9200	Genoa tracks for 105% jib incl. cars with pin stop	<b>1.490 €</b>

## RIG & SAILS

XE1001	Mast, anodized aluminium with manual inmast furling system	<b>3.890 €</b>
XE1010	Mast, anodized aluminium with electric inmast furling system (only with XH1001 or XH1005)	<b>13.990 €</b>
XE1102	Backstay tensioner, hydraulic	<b>2.290 €</b>
XE1210	Electric jib furler (only with XH1001 or XH1005)	<b>11.490 €</b>
XE1220	Second forestay with second furler, manual, incl. tracks (only with XC9171)	<b>6.890 €</b>
XE1221	Second forestay with second furler, electrical, incl. tracks (only with XH1001 or XH1005 and XC9171)	<b>12.790 €</b>
XE2001	Lazy bag with lazy jacks (colour selection - not with XE1001 and XE1010)	<b>1.590 €</b>
XE2009	Canvas windscreen with stainless steel stake (not with XE2010 or XE2012)	<b>3.490 €</b>
XE2010	Fixed windscreen (not with XE2009 and XE2012)	<b>7.390 €</b>
XE2012	Sprayhood with stainless steel stake, 3 windows (1 openable - colour selection - not with XE2009 or XE2010 or XE2051 or XE2052 or XE2053)	<b>3.590 €</b>
XE2013	Canvas cover connecting windscreen and composite hard top (only with XE2010 and XE2051 or XE2052 or XE2053)	<b>3.490 €</b>
XE2021	Bimini with stainless steel stake (colour selection - not with XE2051, XE2052 and XE2053)	<b>4.890 €</b>
XE2049	GRP Targa arch, gelcoat colour: White, with main sheet base (not with XE2012, XE2021 and only with XE1001 or XE1010)	<b>14.990 €</b>
XE2051	GRP hard top for cockpit with canvas sliding roof - outside surface, colour: White (only with XE1001 or XE1010)	<b>29.390 €</b>
XE2052	GRP hard top for cockpit with canvas sliding roof - outside surface painted, non metallic (colour selection - only with XE1001 or XE1010)	<b>34.290 €</b>
XE2053	GRP hard top for cockpit with canvas sliding roof - outside surface painted, metallic (colour selection - only with XE1001 or XE1010)	<b>36.790 €</b>
XE2060	T-Top not mounted	<b>1.090 €</b>
XE3001	ELVSTRØM Blue Water Dacron sails - full battened, main and jib (with XE1001 and XE1010 no battens)	<b>2.490 €</b>
XE3005	ELVSTRØM SPS performance sails - full battened, triradial main and jib	<b>7.390 €</b>
XE3010	ELVSTRØM HPM high - performance sails, full battened, UV protected membran, main and jib	<b>15.290 €</b>
XE3021	ELVSTRØM SPS performance sail - 105% Jib with sheets (only with XC9200)	<b>4.490 €</b>
XE3023	ELVSTRØM Blue Water Dacron sail - for second forestay, vertical battens, Reacher 145% (only with XE1220 or XE1221)	<b>3.190 €</b>

XE3024	ELVSTRØM SPS performance sails - for second forestay, vertical battens, triradial, Reacher 145% (only with XE1220 or XE1221)	<b>8.390 €</b>
XE3025	ELVSTRØM HPM high - performance sail - for second forestay, UV protected membrane, Reacher 145% (only with XE1220 or XE1221)	<b>16.290 €</b>
XE9100	Spreader lights, LED, 4 up and 4 down	<b>3.390 €</b>

## NAVIGATION & INSTRUMENTS

XF4000	Raymarine AXIOM PRO 9 S chart plotter with HybridTouch multifunction display at chart table (only with Layout C2)	<b>3.390 €</b>
XF4500	Raymarine Quantum 2 Radar (only with chart plotter)	<b>3.890 €</b>
XF4560	MyHanse Safety Cloud hardware with 30 days free trial subscription and an interior light, switchable by APP	<b>1.490 €</b>
XF4600	Raymarine AIS Class B transponder (only with chart plotter and XK5000)	<b>1.590 €</b>
XF4650	Thermal vision camera at mast (only with Navigation Package)	<b>6.390 €</b>
XF4653	SEA.AI Offshore ONE (only with Navigation Package)	<b>11.590 €</b>
XF4701	Raymarine RealVision-3D Sonar (only with chart plotter)	<b>2.890 €</b>

## PROPULSION

XG1103	Engine (Diesel, approx. 110 hp) - saildrive, 3-blade folding propeller and throttle control on instrument pod stb	<b>14.090 €</b>
XG1003	Engine (Diesel, approx. 80 hp) - saildrive, 3-blade folding propeller	<b>2.490 €</b>
XG3101	Bowthruster, 24 V, retractable, incl. battery	<b>12.090 €</b>
XG3201	Sternthruster, 24 V, retractable, incl. battery (only with XG3101)	<b>13.990 €</b>
XG3213	Electronic throttle control on instrument pod (helm station, stb) (not with XG1103 and only with Navigation Package)	<b>4.390 €</b>
XG3211	Add. electronic throttle and thruster control at helm position, on port (only with XG3213 or XG1103)	<b>1.890 €</b>

## EQUIPMENT

XH1110	Deep charge protection for service batteries	<b>1.390 €</b>
XH1601	Country Version: US / JPN	<b>3.090 €</b>
XH2201	Inverter/charger, 12 V / 2600 W - 100 A, incl. AC panel (only with XH1001 or XH1005)	<b>3.490 €</b>
XH2080	Solar panel integrated in hard top (only with GRP hard top)	<b>14.990 €</b>
XH2101	Generator 8000i, 6,4 kW / 0 - 7,2 kVA incl. maintenance kit	<b>19.490 €</b>
XH2102	Generator 10000i, 8,0 kW / 0 - 9,0 kVA incl. maintenance kit	<b>23.090 €</b>
XH3021	Electric toilet with sea water flush - cabin layout B1, B2 or B3	<b>1.690 €</b>
XH3026	2 electric toilets with sea water flush - cabin layout B4 or B5	<b>3.390 €</b>
XH3011	Electric toilet with sea water flush - cabin layout D1 or D2	<b>1.690 €</b>

XH3001	Electric toilet with sea water flush - cabin layout E2 or E3	1.690 €
XH3200	Freshwater dockside connection in cockpit	690 €
XH4011	Heating, hot air with blowers in saloon and aft head (not with XH4100)	4.590 €
XH4100	Heating, hot water ring with blowers in each cabin and head	12.590 €
XH4511	Air conditioning, 40.000 BTU, 3 units: saloon, fwd cabin, aft cabin, incl. 2nd shore power	23.240 €
XH4513	Air conditioning, 8.000 BTU, for crew cabin, (only with XH4511 and XL1002)	6.990 €
XH4514	Air conditioning, 8.000 BTU, for E4 layout, (only with XH4511 and XL5004)	6.990 €
XH5020	Water maker, 12 V, 60 l / h (only with A1 layout and XH1001 or XH1005)	16.790 €
XH5100	Additional fridge in galley (not with XH5121 and XH5210 - only with XH1001 or XH1005)	2.190 €
XH5101	Additional fridge in cockpit on ps	2.190 €
XH5110	Double fridge 140 l in galley (only with C1 layout and XH1001 or XH1005)	2.690 €
XH5112	Wine cooler in galley (only with XH1001 or XH1005)	2.590 €
XH5120	Additional freezer in utility room (only with E1 layout and XH1001 or XH1005)	2.190 €
XH5121	Additional freezer in galley (not with XH5100 and XH5210 - only with XH1001 or XH1005)	2.190 €
XH5150	Microwave in galley	1.790 €
XH5210	Dishwasher in galley (not with XH5100 and XH5121 - only with XH1001 or XH1005)	2.390 €
XH5311	Washing machine with dryer function, front opening, in utility room (only with cabin layout E1)	3.490 €
XH6001	Grey water system for bathrooms and galley, tank: 175 l (not with XH6011)	3.490 €
XH6011	Add. fresh water tank, appr. 175 l (not with XH6001)	3.390 €
XH6021	Add. fuel tank, appr. 175 l	3.590 €

## RADIO & ENTERTAINMENT

XK5000	VHF preparation with antenna and splitter for FM and AIS	490 €
--------	--	-------

## ACCESSORIES

XV9120	Cover for cockpit table (colour selection)	990 €
XV9130	Cover for steering wheels (colour selection)	690 €
XV9380	Shrink wrap foil (for storage purpose only / not for transport) (not with XA1002, XA1003, XE2051, XE2052, XE2053, XE2010)	890 €

## SHIPPING & TRANSPORT

XZ2001	Loading on truck	790 €
XZ2003	Oversea shipping pack (cradle)	3.790 €
XZ2020	Ready for Pickup	690 €

All mentioned prices in €, basic prices ex yard and excl. VAT. All weights and measures are calculated numbers based on the construction data. Changes in construction and equipment reserved.  
Above mentioned prices are recommended for ex yard deliveries within 4 month after order confirmation. For later delivery time the company reserves right to apply latest price list. Company reserves additional 15 working days when painted hull or deck is ordered. All measurements/figures are approximate. Errors and omissions excepted. Specification and material can be changed without notice.  
Valid from 2023.07.01 for deliveries until 2024.12.31.