

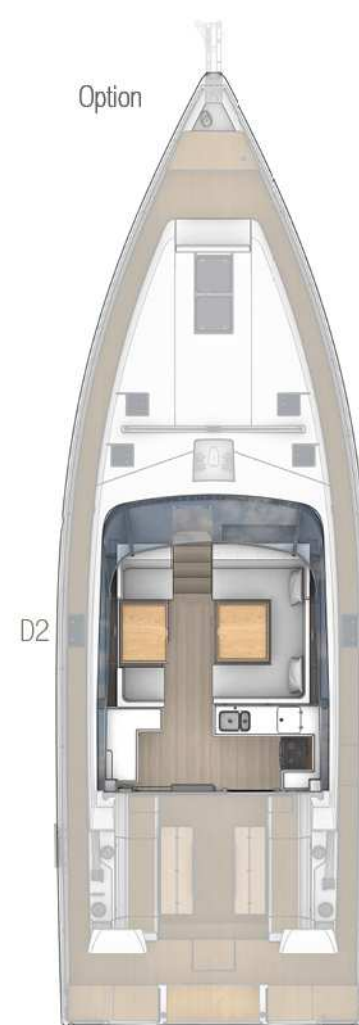

specification
& pricelist
DS48

LOA	15.42 m	50' 7"
LH	14.65 m	48' 1"
LWL	13.83 m	45' 4"
Beam	4.85 m	15' 11"
Draft	2.15 m	7' 1"
	1.80 m	5' 11"
Displacement	21.16 t	46,650 lbs
Engine	110 PS	110 hp
	150 PS	150 hp
Fresh water	766 l	202 gal
Fuel tank	570 l	150 gal
CE Certificate	A - 12	A - 12
Mast lenght above WL	24.09 m	79' 0"
Main approx.	78.70 m ²	847 sq ft
Self-tacking jib approx.	52.20 m ²	562 sq ft
Reacher approx.	86.80 m ²	934 sq ft
Gennaker approx.	170.90 m ²	1,839 sq ft
Total sail area approx.	130.90 m ²	1,409 sq ft
Rlg	I 20.68 m	67' 10"
	J 5.68 m	18' 8"
	P 19.85 m	65' 1"
	E 6.61 m	21' 8"
Design	Dixon Yacht Design	
Interior	Hanse Design Team	

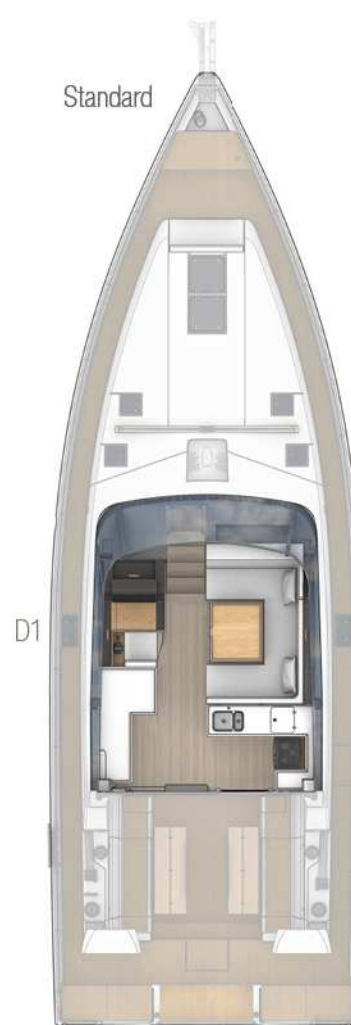

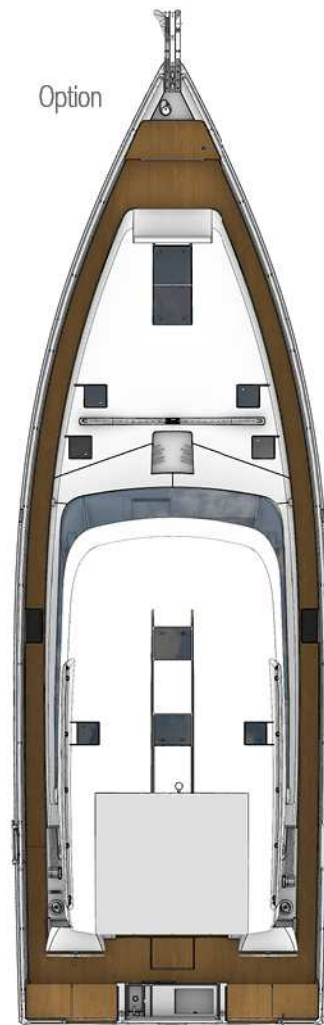

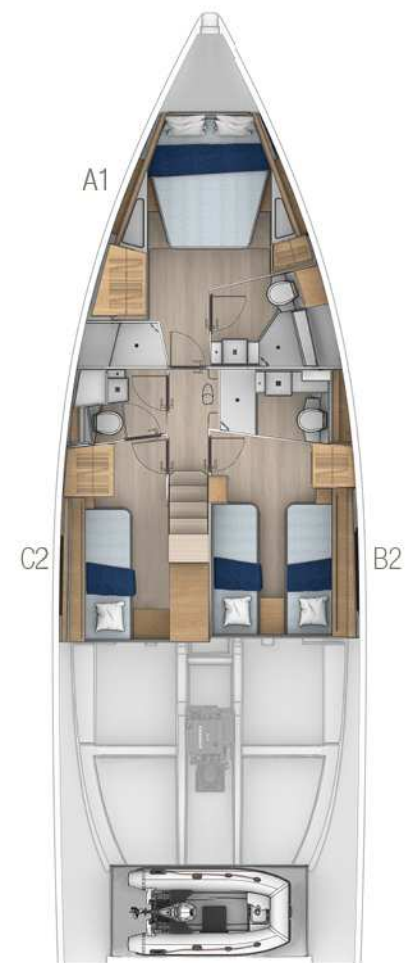
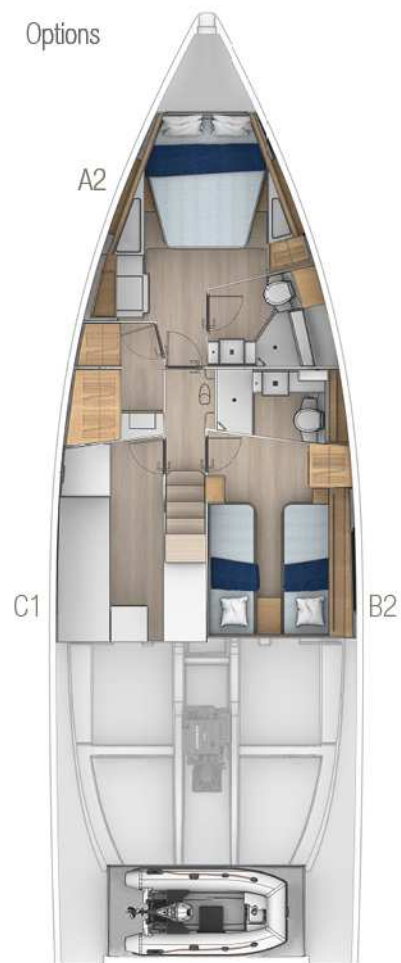
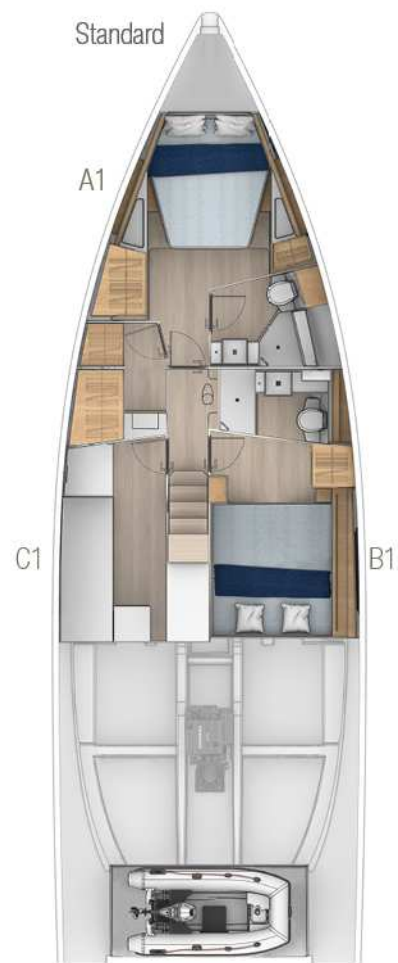

HULL

- 8 hull windows (4 on starboard, 4 on port)
- GRP hull, isophthalic gelcoat: Off White (similar RAL 9003), 1st layer vinyl ester resin and balsa sandwich laminat.
- Waterline and cove line, isophthalic gelcoat colour: Moody Grey (similar RAL 7034)

KEEL

- L-keel, cast iron, draft: 2.15 m
- GRP rudder with sea-water resistant aluminium shaft and selfaligning bearings

LAYOUT & INTERIOR

- A1: Master cabin with island double berth, storage space and ensuite head with separate shower stall
- B1: VIP cabin incl. "King size" bed, storage locker and ensuite head with separate shower stall
- C1: Storage room and walk-in wardrobe for master cabin
- D1: Saloon with full functional transversal galley and dining area on stb - proper chart table with storage room on ps
- 3-burner gas stove with oven, double waste bin, 12 V fridge approx. 135 l, double sink with mixing tab
- Interior furniture in high quality marine plywood, satin varnished
- Galley, coloured, colour: white

- Worktop in galley - Marine Mineral Stone, colour: Grained Black

WOOD (FURNITURE, FLOORBOARD)

- Furniture - Traditional Mahogany - satin varnish
- Floorboard - New Zealand Acacia

UPHOLSTERY

- Comfort mattresses for all berths
- Upholstery - dorset, colour: Cream

DECK & OUTSIDE EQUIPMENT

- GRP deck with antislip surface, gelcoat colour: Off White (similar RAL 9003), 1st layer vinyl ester resin with blasa sandwich core.
- Synthetic teak on side deck, cockpit bottom, helmsman seats, cockpit benches and bathing platform (colour selection)
- Twin wheel steering system
- 2 stainless steel steering wheels with leather cover
- 2 cockpit tables, stainless steel with folding teak tops
- Pulpit and pushpit, stainless steel
- Railing, stainless steel tube and wire, incl. integrated boarding ladder on both sides
- Halyards and control lines in cockpit at helm position, stern locker, 2 cockpit lockers, 6 retractable mooring cleats, handrail on coach roof, double anchor arm and anchor locker

- 2 LEWMAR 65 EST EVO electrical halyard winches
- Bathing platform, manual fold-out with swimming ladder
- 2 helmsman seats, foldable
- Anchor windlass, electrical, 1500 W, with automatic fuse, remote control with chain counter
- Delta-anchor 40 kg, galvanized with 60 m galvanized chain
- Self tacking jib system
- German mainsheet system
- Sliding door and high/low window in deckhouse
- Panoramic deckssaloon windows, central glass skylight, 2 portlights, 1 fwd. coach roof front window, 2 big and 6 small openable decks hatches

RIG & SAILS

- Rig, anodized aluminium, deck stepped, with kicker, standing and running rigging and 2 reefs
- Backstay tensioner, manual
- Bimini with sliding mechanism (colour selection)
- QUANTUM Blue Water Dacron sails - full battened, main and jib

NAVIGATION & INSTRUMENTS

- Illuminated compass
- Navigation lights - LED

PROPULSION

- Engine (Diesel, approx. 110 hp) - saildrive, 3-blade folding propeller
- Bowthruster, 24 V, incl. battery - tunnel

EQUIPMENT

- 12 V and 230 V electric system, 230 V shore power and sockets in cabins and heads
- Battery set, capacity: 1x 90 Ah + 4x 160 Ah AGM
- Country Version: EU / AUS
- Battery charger
- Shore power 230 V
- Manual toilet with sea water flush - cabin layout B1 or B2
- Electric toilet with sea water flush - cabin layout A1 or A2
- Shower unit in cockpit, warm-/coldwater
- Water akku for pressure equalization
- LPG gas system, stowage for 2 gas bottles
- Blackwater system (appr. 85 l per head) with deck extraction and seacock for head
- Freshwater system with electric pump and 40 l hotwater, heated also by main engine
- Fresh water tank, appr. 766 l
- Fuel tank, approx. 570 l
- Fuel filter

ACCESSORIES

- Blind set with flyscreens for deck hatches
- Skysol blinds for deckshouse windows
- Venetian blinds for hull windows
- Wind indicator
- Flagpole
- Add. winch handle
- Mast steps

SHIPPING & TRANSPORT

- CE - Certificate cat. A-12, B-14, C-16
- Owners manual
- EC - Type Examination Certificate

standard pricelist packages DS48

AS PER STANDARD SPECIFICATION

excl. VAT
864.900 €

XW2000 Raymarine Navigation Package 16.400 €

XF2210	2 Raymarine i70s multifunction displays at helm position, incl. transducer (speed/wind/depth/temperature)
XF3000	Raymarine VHF RAY90 at chart table, incl. handset
XF4010	2 Raymarine Axiom 9" GPS chart plotter, one per helm position
XF4600	AIS Class B transponder
XF5000	Raymarine Evolution Autopilot with p70Rs display and S100 remote control at helm position, port
XF9001	NMEA Engine information interface for chart plotter
XK5000	VHF preparation with antenna and splitter for FM and AIS

XW2001 Upgrade - Axiom Pro 2.400 €

XF4011	2 Raymarine Axiom Pro 9" GPS chart plotter, one per helm position
--------	---

XW2005 Upgrade - 3rd Helmsmanstation at chart table 4.100 €

XF5110	Raymarine p70Rs Autopilot display at chart table
XG2101	Add. electronic throttle control and thruster control at chart table

XW6500 Smart Connection Package 3.550 €

XF4655	Interior camera
XK5031	WLAN router incl. booster antenna

XW7000 Entertainment Package - Saloon and cockpit 3.750 €

XK1000	FUSION APOLLO MS-RA770 Multimedia radio with Wi-Fi and touchscreen - for saloon and cockpit (only with XK5000)
--------	--

XK2000	2 high-end 2-way speakers in saloon and cockpit
XK3070	FUSION MS-ERX400 remote control in cockpit

XW7010 Entertainment Package - Master cabin 2.400 €

XK1010	FUSION APOLLO MS-RA770 Multimedia radio with Wi-Fi and touchscreen - for master cabin (only with XK5000)
XK2010	2 high-end 2-way speakers in master cabin

XW7030 TV Package - Saloon 3.650 €

XK4040	TV preparation in saloon
XK4140	LED TV flat screen in saloon
XK4240	TV lifting system in saloon

XW7040 TV Package - Master cabin (only with XW7030) 2.750 €

XK4010	TV preparation in master cabin
XK4110	LED TV flat screen in master cabin

XW7050 TV Package - VIP cabin (only with XW7030) 2.750 €

XK4060	TV preparation in VIP cabin
XK4160	LED TV flat screen in VIP cabin

standard pricelist options

DS48

		excl. VAT
HULL		
XA1001	GRP hull, coloured gelcoat (colour selection)	6.500 €
XA1002	GRP hull, painted, non metallic (colour selection)	30.450 €
XA1003	GRP hull, painted, metallic (colour selection)	37.300 €
XA3001	Waterline and cove line, coloured gelcoat (colour selection - only with XA1000 or XA1001)	1.050 €
XA3002	Waterline and cove line, painted, non metallic (colour selection - only with XA1002 or XA1003)	1.150 €
XA3003	Waterline and cove line, painted, metallic (colour selection - only with XA1002 or XA1003)	2.300 €
KEEL		
XB1001	L-keel, cast iron, draft: 1.80 m	13.650 €
XB9000	Keel and rudder - not mounted	1.050 €
LAYOUT & INTERIOR		
XL1002	A2: Master cabin with island double berth, desk, storage space and ensuite head with separate shower stall (only with layout C1)	1.050 €
XL2002	B2: VIP cabin with two single berth, storage locker and ensuite head with separate shower stall	950 €
XL3002	C2: Guest cabin with single berth, storage locker and ensuite head with separate shower stall	4.750 €
XL3003	C3: Guest cabin with double berth and ensuite head with separate shower stall	5.550 €
XL4002	D2: Saloon with full functional transversal galley and dining area on stb - chart table in dinette style on ps	1.650 €
XL6050	Day head door for head (not with layout C1)	1.350 €
XL6202	Galley, coloured, colour: dark grey	1.650 €
XL6203	Galley in wood colour	1.750 €

XL7001	Saloon table electrically lowerable with cushions, convertible into double berth	2.950 €
XL7190	Chart table electrically lowerable with cushions, convertible into berth (only with layout D2)	2.950 €
XL7601	Worktop in galley - Marine Mineral Stone (colour selection)	1.050 €

WOOD (FURNITURE, FLOORBOARD)

XM1102	Furniture - Teak	10.500 €
XM1104	Furniture - Golden Oak	10.500 €
XM1150	Furniture - High Gloss Finish (only with XM1100)	13.750 €
XM1201	Floorboard - Continental Oak	1.450 €

UPHOLSTERY

XN2001	Upholstery - oxford (colour selection)	1.450 €
XN2002	Upholstery - devon (colour selection)	2.100 €
XN2003	Upholstery - orkney (colour selection)	3.150 €
XN2004	Upholstery - yorkshire leather (colour selection)	6.100 €
XN2200	Sun bed cushions on foredeck (colour selection)	2.400 €
XN2501	Cockpit cushions with backrest (colour selection)	3.450 €
XN2505	Cushion for wetbar (colour selection - only with XC3100)	950 €
XN4001	Curtains for saloon sliding door (colour selection)	1.150 €

DECK & OUTSIDE EQUIPMENT

XC1360	Real teak on side deck, cockpit bottom, helmsman seats, cockpit benches and bathing platform	4.150 €
XC2201	2 GRP steering wheels, Y-spoke (black or white)	2.000 €
XC3004	2 cockpit tables, aluminium foot with teak tops, electrically lowerable into sunbed incl. upholstery	5.650 €
XC3100	Wetbar with BBQ and sink with mixing tab	6.300 €
XC3110	Add. storage space instead of wetbar in cockpit	4.550 €
XC3400	Foredeck dinette with teak table, upholstery and storage for the table	4.150 €

standard pricelist options

DS48

XC5200	2 LEWMAR 55 ST EVO manual secondary winches	4.750 €
XC5202	2 LEWMAR 55 ST EVO electrical secondary winches with automatic fuse	14.050 €
XC6005	Automatic driven fold-out for standard bathing platform with remote control and comfort stairs to the bathing platform	9.400 €
XC6008	Swimming stairs, extractable, manual (only with XC6005)	3.550 €
XC7001	Moody Smart Tender System (only with XC6005)	9.400 €
XC7100	Air compressor for tender	1.050 €
XC7200	Davits for dinghi	3.550 €
XC9020	Rub rail, teak	3.550 €
XC9021	Additional stainless steel rail (only with XC9020)	3.150 €
XC9036	LED lights for side decks, integrated in toerail, white	3.650 €
XC9050	Electrical deck wash pump inside anchor locker	1.250 €
XC9101	Delta-anchor 40 kg, stainless steel, with swivel and 100 m stainless steel chain	7.250 €

RIG & SAILS

XE1001	Rig, anodized aluminium with manual inmast furling system	6.300 €
XE1010	Rig, anodized aluminium with electric inmast furling system	13.650 €
XE1210	Electric jib furler	12.050 €
XE1220	Second forestay with furler, manual and genoa tracks with pin stop (only with XC5200)	7.650 €
XE1221	Second forestay with furler, electrical and genoa tracks with pin stop	13.750 €
XE3005	QUANTUM AC5 performance sails - full battened, triradial, main and jib	8.600 €
XE3010	QUANTUM TP6 high-performance sails - full battened, UV-protected membrane, main and jib	16.150 €
XE3024	QUANTUM AC5 Genoa 135% (only with XE1220 or XE1221)	9.000 €
XE3025	QUANTUM TP6 Genoa 135%, with UV protection (only with XE1220 or XE1221)	15.750 €
XE3105	QUANTUM Gennaker incl. squeezer (colour selection)	5.250 €
XE9004	Gennaker package incl. halyard, 2 sheets, 2 blocks and padeyes	2.950 €
XE9100	Spreader lights, LED, 6 up and 6 down	3.550 €

NAVIGATION & INSTRUMENTS

XF4000	Raymarine Axiom Pro 12" GPS chart plotter at chart table (only with D1 layout)	5.650 €
XF4500	Raymarine Quantum 2 Radar, on first spreader	4.250 €
XF4560	MyMoody Safety Cloud hardware with 30 days free trial subscription and an interior light, switchable by APP	1.550 €
XF4650	Thermal vision camera at mast (only with Navigation Package)	6.700 €
XF4653	SEA.AI Offshore ONE (only with Navigation Package)	12.150 €
XF5001	2nd redundant autopilot engine (only with XF5000)	2.550 €

PROPULSION

XG1103	Engine (Diesel, approx. 150 hp) - saildrive, 3-blade folding propeller	9.650 €
XG1810	Add. electronic throttle control and thruster control at helm position, on port	4.850 €
XG3201	Sternthruster, 24 V, retractable, incl. battery (only with XG3101)	16.400 €

EQUIPMENT

XH1005	Battery set, capacity: 1x 90 Ah + 800 Ah Lithium	10.500 €
XH1110	Deep charge protection for service batteries	1.450 €
XH1601	Country Version: US / JPN	3.650 €
XH2080	Solarpanels on coach roof	11.550 €
XH2085	Fuel Cell Pro2800BT max. 125 W	9.400 €
XH2101	Generator 10000i, 8,0 kW / 0 - 9,0 kVA, incl. maintenance kit	24.250 €
XH2201	Inverter/charger, incl. AC panel	4.150 €
XH3001	Electric toilet with sea water flush - cabin layout C2 or C3	2.000 €
XH3021	Electric toilet with sea water flush - cabin layout B1 or B2	2.000 €
XH3200	Freshwater dockside connection in transom	650 €
XH4100	Heating, hot water ring with blowers in each cabin and head	13.150 €
XH4510	Air conditioning, 37.000 BTU, 3 units: saloon, master cabin and VIP cabin on stb, incl. 2nd shore power	27.300 €

standard pricelist options

DS48

XH4511	Air conditioning, 8.000 BTU, 1 unit: C-layout (only with XH4510)	10.800 €
XH5020	Water maker, 230 V, 200 l / h (only with XH2101)	25.200 €
XH5100	Add. fridge in saloon on port (only with layout D2)	2.300 €
XH5101	Add. fridge in galley on port (not with XH5102)	2.300 €
XH5102	Double fridge in galley on port (not with XH5101 or microwave)	3.050 €
XH5103	Double fridge in galley on port (only with layout D1)	3.050 €
XH5110	Add. fridge in saloon (nav station) on port (only with layout D1)	2.300 €
XH5111	Add. fridge in wetbar	2.300 €
XH5120	Freezer in utility room (only with layout C1)	3.050 €
XH5150	Microwave in saloon (not with XH5102)	1.900 €
XH5210	Dishwasher in saloon	2.500 €
XH5311	Washing machine with dryer function (layout C1 & C2 in locker, layout C3 instead of separate shower)	3.650 €
XH6001	Grey-water system for bathrooms and galley, tank: 175 l	2.300 €
XH6031	Double fuel filter	1.950 €

RADIO & ENTERTAINMENT

XK5000	VHF preparation with antenna and splitter for FM and AIS	600 €
--------	--	-------

ACCESSORIES

XV9045	External sunshade for deckshouse windows (colour selection)	3.050 €
XV9120	Cover for cockpit table (colour selection)	700 €
XV9130	Cover for steering wheels (colour selection)	950 €
XV9380	Shrink wrap foil (for storage purpose only / not for transport) (not with XA1002, XA1003, XA3002, XA3003)	1.050 €
XV9901	8 fenders	700 €
XV9902	6 mooring lines, plaited	500 €

SHIPPING & TRANSPORT

XZ2001	Loading on truck	750 €
XZ2003	Oversea shipping pack (cradle)	3.550 €
XZ2020	Ready for Pickup	750 €

All mentioned prices in €, basic prices ex yard and excl. VAT. All weights and measures are calculated numbers based on the construction data. Changes in construction and equipment reserved. Above mentioned prices are recommended for ex yard deliveries within 4 month after order confirmation. For later delivery time the company reserves right to apply latest price list. Company reserves additional 15 working days when painted hull or deck is ordered. All measurements/figures are approximate. Errors and omissions excepted. Specification and material can be changed without notice. Valid from 2024.07.01 for deliveries until 2025.06.30.