

# PRICELIST & SPECIFICATION



|                      |         |                       |             |
|----------------------|---------|-----------------------|-------------|
| LOA                  | approx. | 11.32 m               | 37' 2"      |
| Hull length          | approx. | 10.60 m               | 34' 9"      |
| LWL                  | approx. | 10.29 m               | 33' 9"      |
| Beam                 | approx. | 3.99 m                | 13' 1"      |
| Draft                |         |                       |             |
| T-keel, medium       | approx. | 2.15 m                | 7" 1"       |
| Displacement         |         |                       |             |
| T-keel, medium       | approx. | 8.37 t                | 18,453 lbs  |
| Engine               |         |                       |             |
| Diesel-standard      | approx. | 29.00 PS              | 29.00 hp    |
| Diesel-option        | approx. | 39.00 PS              | 39.00 hp    |
| Electric 18kW/h      | approx. | 25 kW                 | 25 kW       |
| Electric 36kW/h      | approx. | 25 kW                 | 25 kW       |
| Fuel tank            | approx. | 160 l                 | 42 gal      |
| Fresh water          | approx. | 345 l                 | 91 gal      |
| Mast length above WL | approx. | 17.60 m               | 57' 9"      |
| Total sail area      | approx. | 73.00 m <sup>2</sup>  | 787 sq ft   |
| Main sail            | approx. | 40.00 m <sup>2</sup>  | 431 sq ft   |
| Self-tacking jib     | approx. | 28.00 m <sup>2</sup>  | 301 sq ft   |
| Genoa                | approx. | 33.00 m <sup>2</sup>  | 355 sq ft   |
| Crossover            | approx. | 71.00 m <sup>2</sup>  | 764 sq ft   |
| Gennaker             | approx. | 112.00 m <sup>2</sup> | 1,206 sq ft |

|                |                    |
|----------------|--------------------|
| CE Certificate | A-6                |
| Design         | Berret - Racoupeau |
| Interior       | Berret - Racoupeau |

# 360ST

All measurements/figures are approximate. Errors and omissions excepted. All weights are specified in MLC. Specification and material can be changed without notice. Valid from 2025.04.24. Only for PROTOTYPES

# 360ST DECK LAYOUT & CABIN CONCEPT

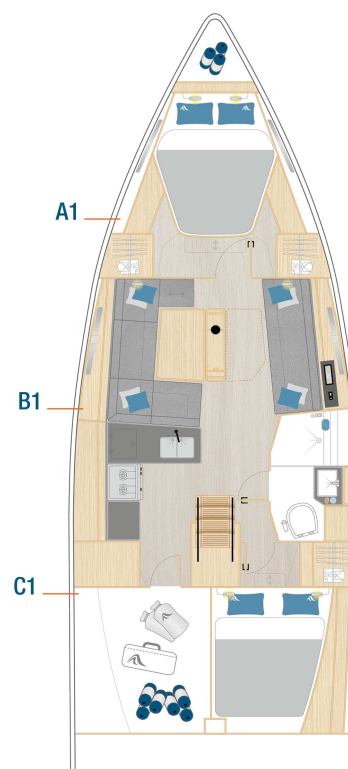
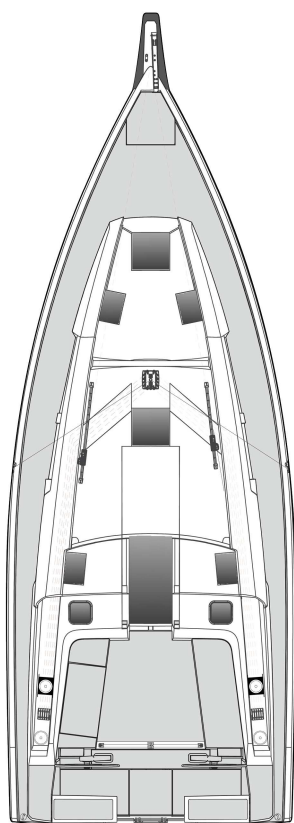

Standard

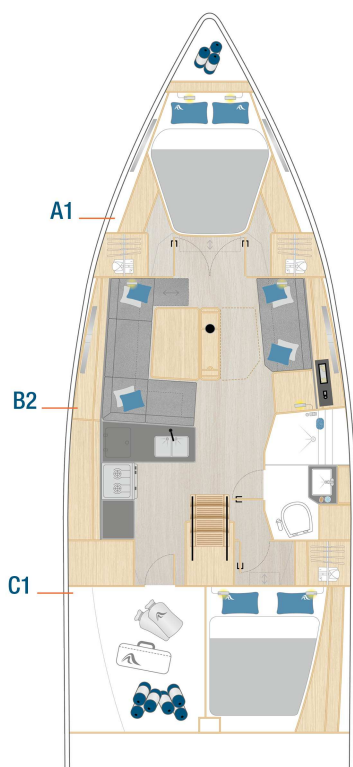

Option

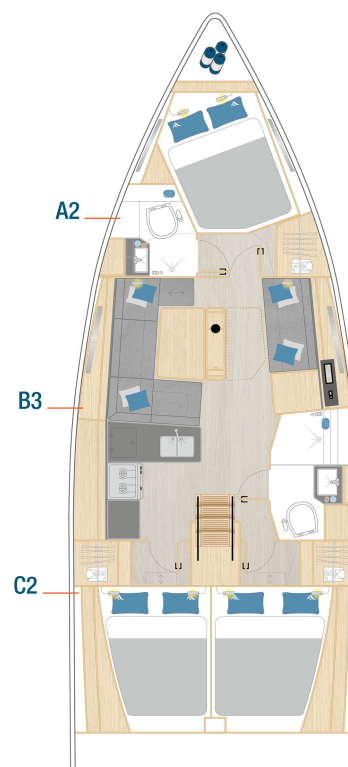

Option

## HULL

- 6 hull windows (3 each side) similar like hull colour
- GRP hull, isophthalic gelcoat, colour: Signal White (similar RAL 9003), 1st layer vinyl ester resin and balsa sandwich laminat
- Waterline, isophthalic gelcoat, colour: Dark Grey (similar RAL 7043)

## KEEL

- T-keel, cast iron, draft: 2.15 m
- ST-Line GRP rudder with stainless steel shaft and selfaligning bearings

## LAYOUT & INTERIOR

- A1: Master cabin with island double berth and storage space
- B1: Saloon with large dining area on port and sofa on stb
- C1: Large L-galley and storage space on port. Head with separate shower stall, aft cabin with double berth, locker and storage on stb
- 2-burner gas stove with oven, waste bin, 12 V fridge approx. 135 l, double stainless steel sink with mixing tab
- Interior Design package ST-Line (black watertap, black reading lights, black down lights, black mast pole, black handrails). Interior furniture in high quality marine plywood, Satin Varnish
- Hanse companionway closing system
- Saloon table, fixed with integrated storage
- Worktop in galley and heads - Grey

## WOOD (FURNITURE, FLOORBOARD)

- Furniture - Mahogany Style, Satin Varnish
- Cupboard fronts coloured (selected fronts as per design - colour selection)
- Floorboard - Acacia

## UPHOLSTERY

- Mattresses for all berths
- Upholstery - Monte Carlo, colour: Cream
- ST-Line upholstery in saloon

## DECK & OUTSIDE EQUIPMENT

- GRP deck with antislip surface, isophthalic gelcoat, colour: Signal White (similar RAL 9003), 1st layer vinyl ester resin with PET foam core. 1 cockpit locker, 1 space for life raft, stern locker, stowage for running rigging at helm position, anchor locker at bow.

- Twin wheel steering system with emergency tiller
- 2 GRP steering wheels, Y-spoke (black or white)
- ST-Line cockpit table, stainless steel with folding teak tops
- Pulpit and pushpit, stainless steel, colour: black
- Railing, incl. black stanchions and black covered dyneema rope
- Covered halyards and control lines lead to cockpit helmposition, organizers and jammers, 6 black mooring cleats, black handrails on coach roof
- 2 LEWMAR 45 ST RACE EVO manual halyard winches
- 2 LEWMAR 45 ST RACE EVO manual secondary winches
- Swimming ladder
- Helmsman footrests (free mountable)
- Anchor windlass, electrical, with automatic fuse and remote control with chain counter
- Delta-anchor 16 kg, galvanized with 30 m galvanized chain
- Composite bowsprit with integrated anchor and forestay fitting with mooring roll incl. Crossover and Gennaker tack point
- Genoa tracks incl. cars, adjustable from cockpit
- Self tacking jib system
- German mainsheet system with adjustable traveller
- 2 large and 6 small deck hatches - openable, anchor locker hatch
- 4 large coach roof side windows - openable, 3 portlights in coach roof

## RIG & SAILS

- Rig (ST-Line), anodized aluminium with dyform rigging, deck stepped, with kicker, standing and running rigging and 2 reefs and ST-Line backstay, adjustable from both sides
- Manual jib furler
- ELVSTRØM SPS performance sails - full battened, triradial main and jib
- Dyneema halyards for main and jib
- Mainsail slider system

## NAVIGATION & INSTRUMENTS

- Illuminated compass in cockpit
- Navigation lights - LED

## PROPULSION

- Fuel tank, approx. 160 l
- Engine (Diesel, approx. 29 hp) - saildrive, 2-blade fix propeller
- Spinlock removable throttle

## EQUIPMENT

- 12 V and 230 V electric system with main panels and 230 V shore power and sockets in cabins and heads
- AGM battery set, capacity: 1x 90 Ah + 2x 160 Ah AGM
- Country Version: EU / AUS
- Battery charger
- Manual toilet with sea water flush - cabin layout C
- Shower unit in cockpit, warm-/coldwater
- Water akku for pressure equalization
- LPG gas system, stowage for 1 gas bottle
- Black water system (appr. 54 l each bathroom) with deck extraction and seacock for head, electric and manual bilge pump
- Fresh water system with electric pump and 20 l hot water, heated also by main engine
- Fresh water tank, appr. 345 l

## ACCESSORIES

- Wind indicator
- Flagpole
- 6 fenders
- 4 mooring lines
- Add. winch handle
- Mast steps
- Hanse maintenance kit

## SHIPPING & TRANSPORT

- CE - Certificate cat. A - 6
- Owners manual
- EC - Type Examination Certificate

AS PER STANDARD SPECIFICATION

excl. VAT  
225.900 €

## PACKAGES

### XW2000 Raymarine Navigation Package 5.850 €

- XF2200 2 Raymarine i70s multifunction displays in cockpit, incl. transducer (depth/speed/temperature) and RSW Wired Smart Wind transducer
- XF4010 Raymarine AXIOM PRO 9 S chart plotter with HybridTouch multifunction display at cockpit table

### XW2002 Upgrade - Navigation Package 6.200 €

- XF3000 Raymarine VHF Ray63 in saloon, incl. wireless remote handset (only with XK5000)
- XF5000 Raymarine Evolution Autopilot with p70s display and wireless remote control
- XK5000 VHF preparation with antenna and splitter for FM and AIS

### XW2003 Upgrade - Mast Display 4.250 €

- XF2240 Raymarine Alpha 9" multifunction display at mast

### XW5000 Comfort Package 4.950 €

- XC9032 Courtesy lights in cockpit
- XC9033 Courtesy lights at companionway
- XC9040 Exterior Light Signature
- XC9300 Vent for coach roof hatch
- XL9003 Indirect lights in saloon and cabins
- XL9004 LED overhead lights in saloon and master cabin
- XN2500 Cockpit cushions (colour selection)
- XV9010 Blind set with flyscreens for deck hatches
- XV9060 Blinds for hull windows
- XV9080 Blinds for side coach roof windows

### XW6500 Smart Connection Package 3.550 €

- XF4655 Interior camera
- XK5031 WLAN router incl. booster antenna

## XW7000 Entertainment Package 2.200 €

|        |   |
|--------|---|
| XH2090 | Wireless charging in saloon   |
| XK1000 | FUSION MS-RA70N Multimedia radio with bluetooth - for saloon and cockpit (only with XK5000) |
| XK2000 | 2x 2 speakers in saloon and cockpit   |
| XK3070 | FUSION MS-NRX remote control in cockpit   |

## XW7001 Upgrade - Premium Radio 1.050 €

|        |  |
|--------|--|
| XK1001 | FUSION APOLLO MS-RA770 Multimedia radio with Wi-Fi and touchscreen - for saloon and cockpit (only with XK5000) |
| XK3071 | FUSION MS-ERX400 remote control in cockpit   |
| XK5030 | FUSION wireless link - remote control via mobile devices   |

## XW7030 TV Package - Saloon 1.750 €

|        |                              |
|--------|------------------------------|
| XK4040 | TV preparation in saloon     |
| XK4100 | LED TV flat screen in saloon |
| XK5020 | DVB-T2 antenna for TV        |

## OPTIONS

excl. VAT

### HULL

|        |   |         |
|--------|---|---------|
| XA1001 | GRP hull, gelcoat colour: Grey (similar RAL 7040) | 3.850 € |
| XA3001 | Waterline, coloured gelcoat (colour selection)    | 600 €   |

### KEEL

|        |                               |       |
|--------|-------------------------------|-------|
| XB9000 | Keel and rudder - not mounted | 800 € |
|--------|-------------------------------|-------|

### LAYOUT & INTERIOR

|        |  |         |
|--------|--|---------|
| XL1002 | A2: Master cabin with double berth, storage space and separate head  | 5.500 € |
| XL2002 | B2: Saloon with large dining area on port and sofa with chart table on stb   | 1.150 € |
| XL2003 | B3: Saloon with large dining area on port and sofa with multi function unit, navigation console and storage on stb   | 1.550 € |
| XL3002 | C2: L-galley on port and head with separate shower stall on stb. 2 aft cabins with double berth, locker and storage. | 2.800 € |
| XL6051 | Double door in main bulkhead (only with A1 layout)   | 2.700 € |
| XL7001 | Saloon table, foldable with integrated bar   | 1.450 € |



|        |   |         |
|--------|---|---------|
| XL7201 | Seating area in saloon convertible into double berth (only with XL7001) | 1.450 € |
|--------|---|---------|

## WOOD (FURNITURE, FLOORBOARD)

|        |                               |         |
|--------|-------------------------------|---------|
| XM1102 | Furniture - Teak              | 3.850 € |
| XM1103 | Furniture - Canadian Chestnut | 3.850 € |
| XM1104 | Furniture - French Oak        | 3.850 € |
| XM1201 | Floorboard - Classic Stripes  | 1.900 € |
| XM1202 | Floorboard - Noce Nero        | 800 €   |
| XM1203 | Floorboard - Delight Oak      | 800 €   |

## UPHOLSTERY

|        |  |         |
|--------|--|---------|
| XN2001 | Upholstery - Sorrento (colour selection)                         | 800 €   |
| XN2002 | Upholstery - Florence (colour selection)                         | 1.300 € |
| XN2003 | Upholstery - Monaco (colour selection)                           | 1.700 € |
| XN2004 | Upholstery - Portofino Leather (colour selection)                | 3.500 € |
| XN2400 | Sun bed cushions on coach roof (colour selection)                | 1.200 € |
| XN2500 | Cockpit cushions (colour selection)                              | 1.400 € |
| XN2503 | Cushion for helmsman seats (colour selection - only with XC9060) | 600 €   |

## DECK & OUTSIDE EQUIPMENT

|        |  |          |
|--------|--|----------|
| XC1101 | Side decks and cockpit bottom, gelcoat colour: Grey (similar RAL 7040)   | 1.150 €  |
| XC1300 | Real teak on side deck   | 12.250 € |
| XC1301 | Synthetic teak on side deck (colour selection)                           | 11.850 € |
| XC1310 | Real teak on coach roof  | 5.700 €  |
| XC1311 | Synthetic teak on coach roof (colour selection)                          | 5.300 €  |
| XC1325 | Real teak on cockpit bottom  | 3.950 €  |
| XC1326 | Synthetic teak on cockpit bottom (colour selection)                      | 3.250 €  |
| XC1333 | Real teak on helmsman seats (only with XC9060)                           | 690 €    |
| XC1334 | Synthetic teak on helmsman seats (colour selection - only with XC9060)   | 900 €    |
| XC1340 | Real teak on cockpit benches   | 2.290 €  |
| XC1341 | Synthetic teak on cockpit benches (colour selection)                     | 2.050 €  |
| XC1350 | Real teak on bathing platform (only with XC6001)                         | 1.690 €  |
| XC1351 | Synthetic teak on bathing platform (colour selection - only with XC6001) | 1.500 €  |
| XC4001 | Gateway stanchion  | 1.050 €  |
| XC5102 | 2 LEWMAR 45 EST RACE EVO electrical halyard winches with automatic fuse  | 7.500 €  |

|        |  |         |
|--------|--|---------|
| XC6001 | Bathing platform, manual fold-out with swimming ladder                                       | 2.500 € |
| XC9020 | Rub rail, teak   | 1.500 € |
| XC9060 | 2 helmsman seats, foldable   | 1.500 € |
| XC9101 | Delta-anchor 16 kg, stainless steel, with 'Power Ball' swivel and 50 m stainless steel chain | 3.850 € |

## RIG & SAILS

|        |   |         |
|--------|---|---------|
| XE1231 | Electric furler CXe25 for Crossover and Gennaker (only with XH1005)                           | 5.900 € |
| XE2001 | Lazy bag with lazy jacks (colour selection)   | 1.200 € |
| XE2012 | ST-Line Sprayhood with stainless steel stake, 3 windows (1 openable - colour selection)       | 2.900 € |
| XE3010 | ELVSTRØM HPM high - performance sails, full battened, UV protected membrane, main and jib     | 8.600 € |
| XE3021 | ELVSTRØM SPS performance sail - 110% Genoa, short battened, triradial                         | 3.900 € |
| XE3022 | ELVSTRØM HPM high - performance sail - 110% Genoa, short battened, UV protected membrane      | 6.700 € |
| XE3100 | ELVSTRØM Gennaker (colour selection)  | 4.300 € |
| XE3101 | ELVSTRØM Top Down Gennaker (colour selection - only with XE1231)                              | 5.600 € |
| XE3110 | Squeezer for Gennaker (only with XE3100)  | 690 €   |
| XE3300 | ELVSTRØM CZ Crossover sail - with CX endless furler and storage bag                           | 5.200 € |
| XE3301 | ELVSTRØM CZ Crossover sail - prepared for electric furler with storage bag (only with XE1231) | 4.500 € |
| XE9003 | Gennaker package incl. halyard, 2 sheets, 2 blocks and padeye (not with XE9004)               | 1.100 € |
| XE9004 | Crossover package incl. 2:1 halyard, 2 sheets, 2 blocks and padeye (not with XE9003)          | 1.300 € |

## NAVIGATION & INSTRUMENTS

|        |  |         |
|--------|--|---------|
| XF4600 | Raymarine AIS Class B transponder (only with chart plotter and XK5000) | 1.650 € |
|--------|--|---------|

## PROPULSION

|        |   |          |
|--------|---|----------|
| XG1001 | Engine (Diesel, approx. 29 hp) - saildrive, 2-blade folding propeller                       | 1.750 €  |
| XG1101 | Engine (Diesel, approx. 39 hp) - saildrive, 2-blade folding propeller                       | 4.950 €  |
| XG1500 | Electric propulsion (approx. 25kW / 18,4kWh battery) - saildrive, 3-blade folding propeller | 42.000 € |
| XG1510 | Electric propulsion (approx. 25kW / 36,7kWh battery) - saildrive, 3-blade folding propeller | 63.050 € |
| XG3101 | Bowthruster, 12 V, retractable, incl. battery   | 9.550 €  |
| XG3201 | Sternthruster, 12 V, retractable, incl. battery (only with XG3101)                          | 13.650 € |

## EQUIPMENT

|        |   |         |
|--------|---|---------|
| XH1005 | Battery set, capacity: 1x 90 Ah + 2x 200 Ah Lithium | 7.350 € |
| XH1601 | Country Version: US / JPN                           | 1.800 € |
| XH2080 | Solar panel on coach roof                           | 5.800 € |



|        |  |          |
|--------|--|----------|
| XH2085 | Fuel Cell Pro 2800 BT max. 125 W   | 10.400 € |
| XH2201 | Inverter/charger, incl. larger AC panel  | 2.950 €  |
| XH3001 | Electric toilet with sea water flush - cabin layout C  | 1.450 €  |
| XH3011 | Electric toilet with sea water flush - cabin layout A2   | 1.450 €  |
| XH4011 | Heating, hot air with blowers in saloon, heads and master cabin  | 4.650 €  |
| XH4021 | Outlet for heating in aft cabin stb (only with XH4011 and layout C1)   | 500 €    |
| XH4022 | Outlet for heating in aft cabins (only with XH4011 and layout C2)  | 700 €    |
| XH4511 | Air conditioning, 12.000 BTU, 1 unit: saloon and master cabin, incl. 2nd shore power                               | 11.750 € |
| XH4514 | Air conditioning, 8.000 BTU, 1 unit: aft cabin (only with XH4511)  | 7.350 €  |
| XH5100 | Additional drawer fridge/freezer combination in multifunction unit (only with layout B3)                           | 2.300 €  |
| XH5101 | Additional drawer fridge/freezer combination in galley (only with layout C1)                                       | 2.300 €  |
| XH5150 | Microwave in galley  | 1.600 €  |
| XH5409 | Gas leak detector  | 1.050 €  |
| XH5610 | Grey water system "Lakes" for bathrooms and galley, tank: 79 l - no hull-through fittings for grey and black water | 2.650 €  |
| XH6001 | Grey water system for bathrooms and galley, tank: 79 l   | 2.850 €  |

## RADIO & ENTERTAINMENT

|        |  |       |
|--------|--|-------|
| XK5000 | VHF preparation with antenna and splitter for FM and AIS | 750 € |
|--------|--|-------|

## ACCESSORIES

|        |  |       |
|--------|--|-------|
| XV9120 | Cover for cockpit table (colour selection)   | 550 € |
| XV9130 | Cover for steering wheels (colour selection) | 550 € |

## SHIPPING & TRANSPORT

|        |                                |         |
|--------|--------------------------------|---------|
| XZ2001 | Loading on truck               | 600 €   |
| XZ2003 | Oversea shipping pack (cradle) | 3.550 € |
| XZ2020 | Ready for Pickup               | 700 €   |

All mentioned prices in €, basic prices ex yard and excl. VAT. All weights and measures are calculated numbers based on the construction data. Changes in construction and equipment reserved.  
 Above mentioned prices are recommended for ex yard deliveries within 4 month after order confirmation. For later delivery time the company reserves right to apply latest price list. Company reserves additional 15 working days when painted hull or deck is ordered. All measurements/figures are approximate. Errors and omissions excepted. Specification and material can be changed without notice.  
 Valid from 2025.04.24. Only for PROTOTYPES